

REPAIR PARTS LIST

MODEL NO. 77



NEW HOLLAND AUTOMATIC PICK-UP BALER

I M P O R T A N T

When ordering repair parts follow the instructions listed below. By so doing, you will be assured of receiving the correct part in the shortest possible time.

1. **Give the Baler model and serial number.**
2. **Write the complete part number as well as the description of the part.**
3. **All orders should be sent to the nearest Authorized New Holland Dealer.**
4. **Give detailed shipping instructions, that is: Railroad station, county; whether shipment is to go by parcel post, air express, express, freight or truck.**

You will always have both the Baler and motor serial numbers handy if you write them here.

Baler serial number

Motor serial number

Insist on genuine New Holland repair parts. For best performance have your Baler serviced by an Authorized New Holland Dealer.

The New Holland Machine Company is continually striving to improve its products.

We must, therefore, reserve the right to make improvements, or changes, when it becomes practical and possible to do so, without incurring any obligation to make changes, or additions, to the equipment sold previously.

TABLE OF CONTENTS

Auger Assembly	20
Auger and Pick-up Driven Assembly	18
Bale Tension Spring Assembly	33
Clutch Tightener, Clutch Tightener Lever Assembly	7
Connecting Rod and Plunger	12-13
Feeder and Pick-up Drive	21
Feed Roll Assembly	20
Flywheel, Pinion Shaft, Pinion Gears	10
Gasoline Line and Tank	9
Jack and Tongue Assembly	6
Knotter Assembly	30-31
Knotter Assembly Complete	32
Knotter Trip Shaft, Twine Fingers and Dogs	25
Main Drive Gears, Main Drive Gear Bearing Flange	11
Main Frame Weld Assembly	32
Metering Wheel Assembly	28-29
Motor Base, Motor Drive Belt Guard, Main Drive Belt	8
Needle Yoke, Needles, Knotter Support	28-29
Over-Center Assembly	26-27
Pick-up Assembly	16-17
Pick-up Lift, Ground Wheels, Feeder Supports	22-23
Pick-up Windguard Assembly	19
Right Side Belt Guards.....	24
Stationary Knife Holder	15
Tension Rail Bale Chute	34
Twine Box and Twine Tension Assembly	34
Wadboard, Wadboard Brace and Wadboard Linkage	14

This is a complete list of repair parts for the Model 77 New Holland Pick-Up Baler.

The plate containing the model and serial number of the Baler is located on the left side main bearing support plate.

Whenever the terms "left and right, or L and R," are used herein, it should be understood to mean from a position facing in direction of Baler travel.

PARTS INDEX

Part No.	Page No.	Part No.	Page No.	Part No.	Page No.
*Z29	11, 20, 21, 23	*H752	14	11536	15
*Z47A	10	*H754	13	11540	27
*Z48L	11	*H755	13	11542	27
*Z48R	11	*H758	11	11543	27
*Z64	29	*H808A	25	11544	27
*Z67	29	*H809A	25	11545	27
*Z72	14	*H812	13	11546	26
*Z118	25	*H813	13	11550	29
*Z141	11	*H814	13	11552	29
*Z150	29	*H823	10	11553	27
*Z163	13	*H828	13	11554	27
*Z168	27	*H830	13	11555	19, 27
*Z200	13	*H850	13	11559	27
*Z222	21	*H853	14	11561	25
*Z223	21	*H859	13	11564	25
*H1	25	*H860	14	11567	26
*H2	23	*H902	13	11568	26
*H4	13	*H903	13	11569	26
*H8	11	*H958	13	11572	26
*H12	21	*H960	17, 20	11574	26
*H13A	27	*H1002	25	11575	25
*H15	26, 27	*H1003L	14	11577	26
*H16	25	*H1003R	14	11578	26
*H21A	13	*H1006	14	11582	31
*H22	27	*H1064	11	11585	29
*H22A	13	*H1070	21	11586	29
*H25	26, 34	*H1075	13	11587	31
*H40	31	*H1077	14	11588	31
*H52	13	*H100H1	31	11589	31
*H55	27	*H102H1	31	11592	27
*H56	25	*H103H1	31	11594	27
*H79	13	*H104H1	31	11597	25
*H80	29	*H105H1	31	11599	25
*H81	29	*H108H1	31	11600	25
*H95	13	*H109H1	31	11602	32
*H98	13	*H117H1	31	11603	29
*H128	31	*H119H1	31	11605	29
*H131	31	*H120H1	31	11607	10
*H136	14	*H121H1	31	11610	7
*H145	14	*H122H1	13	11614	29
*H151	11	*H158A1	31	11621	10
*H178A	11	*H180A1	14	11622	10
*H180	13	*H182A1	29	11624	10
*H380	13	*H185A1	29	11625	10
*H396A	13	*H194A1	21	11634	7
*H409L	14	*H218A1	11	11636	8
*H423	33	*H490H11	6	11643	7
*H439	13	*H807A1	14	11644	7
*H441	11	*H824A1	31	11646	7
*H482	8	*H831A91	31	11655	34
*H484	11	*H836A91	31	11669	32
*H497	25	*H839A1	31	11670	8
*H505	25	*H840A1	31	11673	17
*H509	34	*H841A1	31	11674	11
*H555	31	*H841B11	31	11676	17
*H562	14	*H845B91	31	11677	10
*H598	10	*H847A1	11, 20, 21	11678	17
*H651	14, 17, 18, 23	H1524	31	11679	9
*H671	13	H1529	31	11682	23
*H672	31	H1530	31	11694	23
*H673	31	H1531	31	11695	31
*H674	31	H1532	29	11710	20
*H749	13	H1534	29	11716	21
*H751	13	H1535	7	11720	21

* These parts are interchangeable on Model 77 and Model 76 Balers.

PARTS INDEX

Part No.	Page No.	Part No.	Page No.	Part No.	Page No.
11721	21	12611	27	13550	18
11722	18, 20	12644	6	13555	23
11732	20	12647	6	13574	23
11734	21	12698	34	13611	6
11737	20	12715	21	13662	21
11738	20	12744	13	13733	23
11739	20	12785	19	13775	23
11747	18	12786	15	13803	10
11750	20	12787	27	13845	11
11757	20	12789	26	13848	9
11758	20	12790	19	13850	9
11760	17	12791	17	13852	23
11770	23	12793	15	13879	9
11776	23	13350	14	13885	9
11779	8	13351	34	13891	23
11780	18	13353	10	13896	11
11781	21	13355	18	13899	11
11783	8	13356	17	13900	11
11784	17	13357	17	13935	33
11787	17	13361	34	13936	33
11788	8	13362	17	13957	23
11789	31	13364	17	13958	23
11790	32	13365	23	13960	23
11792	26	13367	17	13987	29
11794	27	13370	17	13991	17
11797	14	13371	17	13992	21
11868	25	13372	18	14001	21
11869	27	13373	21	14031	21
11901	6	13376	29	14066	29
11905	6	13386	20	14146	24
11909	6	13393	20	14147	24
12004	17	13394	11	14148	24
12014	17	13395	21	14149	24
12017	17	13403	20	14163	23
12024	17	13406	13	14199	33
12025	17	13409	13	14200	33
12026	17	13412	13	14352	23
12027	17	13413	13	14355	33
12029	17	13414	8	14356	23
12035	17	13415	8	14359	8
12036	17	13416	18	14360	23
12043	19	13420	9	14363	23
12045	19	13422	13	14364	17
12046	19	13424	18	14365	17
12070	17	13425	13	14375	8
12071	17	13427	14	25057	23
12081	17	13430	33	25083	17
12084	7	13432	34	25110	23
12094	7	13441	34	25183	7
12095	7	13445	34	25184	7
12100	7	13508	17	25193	21
12117	10	13509	17	25230	20
12119	10	13510	17	25263	7
12194	15	13513	23	25450	23
12195	15	13521	17	25451	23
12239	14, 27	13525	23	25452	23
12566	27	13536	23	25577	6
12567	27	13537	23	25578	6
12571	27	13539	23	25579	6
12575	27	13540	23	25604	17
12579	26	13541	23	25605	17
12595	26	13542	23	25564	23
12605	26	13545	23	25773	6
12607	29	13547	23	71935	8
12609	29	13548	23	80802	23
12610	29	13549	23	80803	7

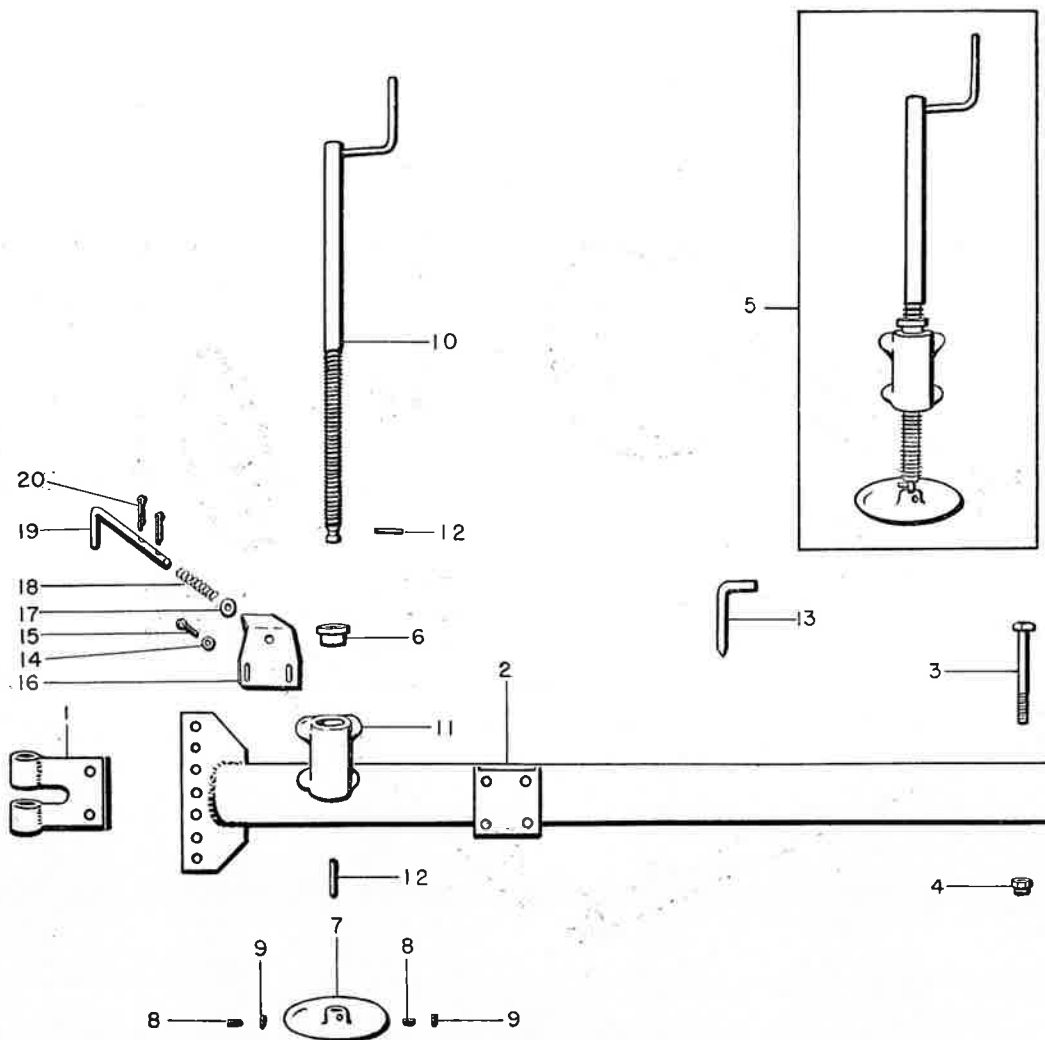

JACK AND TONGUE ASSEMBLY

Ref. No.	Part No.	Description
1	12644	Hitch Assembly
2	13611	Tongue Assembly
3		$\frac{3}{4}$ " x $6\frac{1}{8}$ " Machine Bolt
4		$\frac{3}{4}$ " Elastic Stop
5	11909	Complete Jack Assembly (Consisting of Parts listed under Reference Nos. 6, 7, 8, 9, 10, 11, 12)
6	11901	Locking Collar
7	1490H11	Base
8		$\frac{5}{16}$ " Half Dog Point Set Screw
9		$\frac{5}{16}$ " Jam Nut
10	25573	Jack Screw
11	25574	Screw Bracket with Pin Yoke
12	11905	Pin (2 Used)
13	12647	Tongue Position Pin
14		$\frac{3}{8}$ " Lock Washer
15		$\frac{3}{8}$ " x 1" Cap Screw
16	25578	Jack Safety Bracket
17		$\frac{3}{8}$ " Flat Washer
18	25577	Spring
19	25579	Safety Bracket Handle
20		Cotter Key

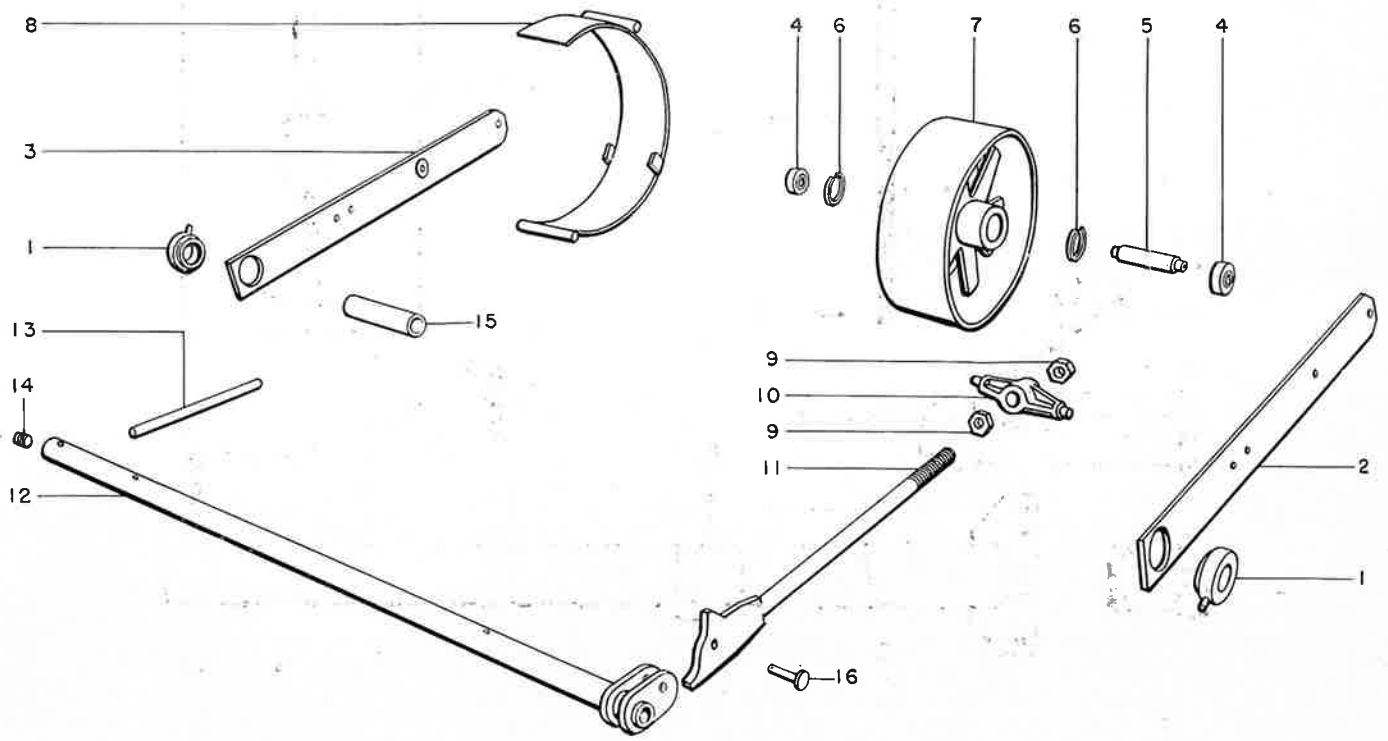

CLUTCH TIGHTENER — CLUTCH TIGHTENER LEVER

Ref. No.	Part No.	Description
1	11610	Tightener Pulley Support Arm Eccentric (2 Used)
2	25184	Tightener Pulley Support Arm (left)
3	25183	Tightener Pulley Support Arm (right)
4	12094	Tightener Pulley Bearing (2 Used)
5	12095	Tightener Pulley Sleeve
6	12084	Tightener Pulley Bearing Retaining Ring (2 Used)
7	11535	Main Drive Belt Tightener Pulley
8	11646	Main Drive Belt Guard (short)
9		5/8" Hex Nut
10	12100	Tightener Pulley Yoke
11	11643	Tightener Pulley Rod
12	11644	Tightener Pulley Engaging Shaft
13	11634	Tightener Pulley Engaging Handle
14		5/8" Hollow Head Set Screw
15	25263	Eccentric Collar Spacer
16	80803	Pin

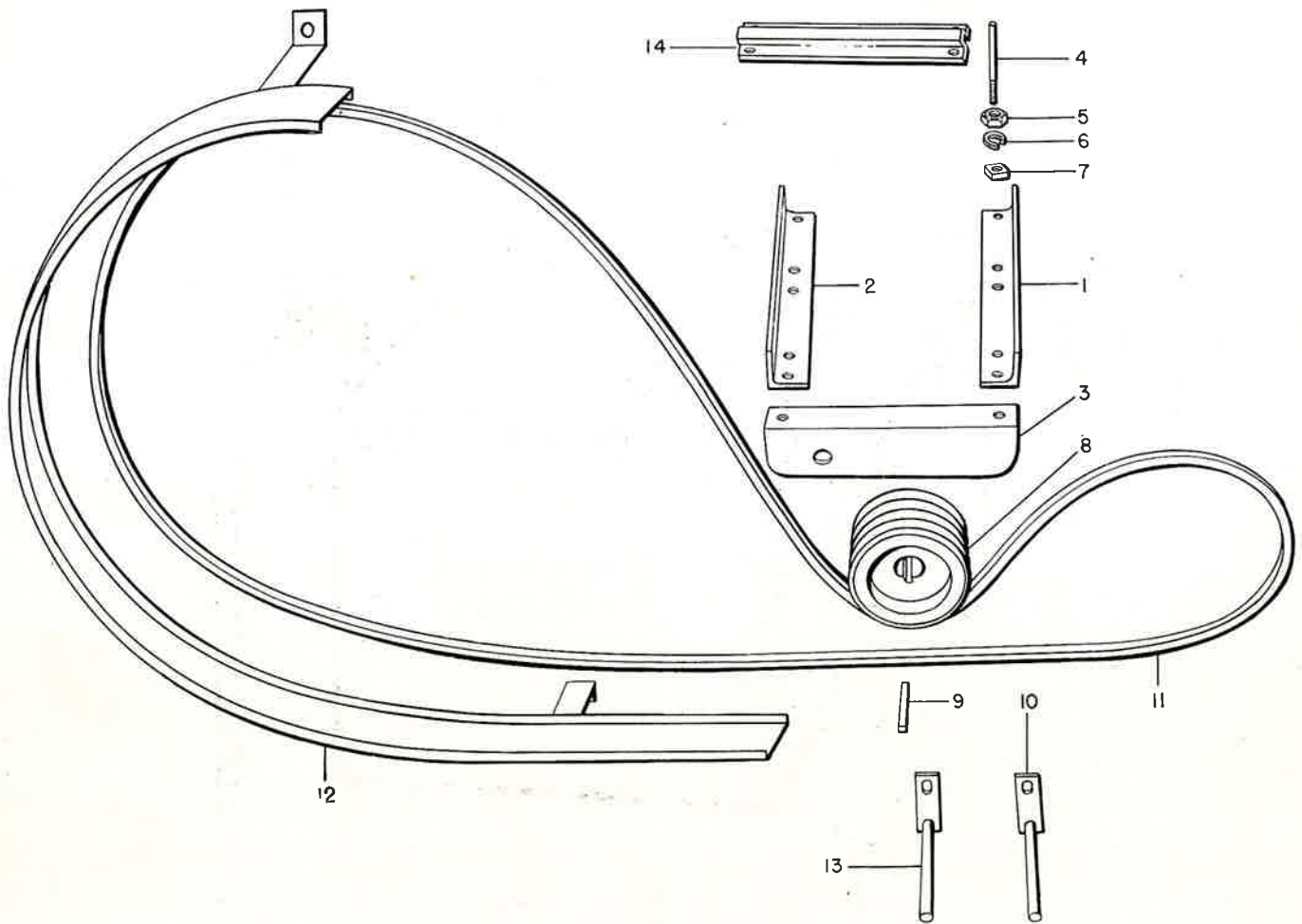

MOTOR BASE, MAIN DRIVE BELT GUARD, MAIN DRIVE BELT

Ref. No.	Part No.	Description
1	11670	Front Engine Support Angle
2	11636	Rear Engine Support Angle
3	11783	Tightener Pulley Engaging Shaft Support
4	13415	Engine Crank Holder
5		1/2" Hex Nut
6		1/2" Lock Washer
7		1/2" Square Nut
8	11788	Motor Drive Sheave
9	H482	Key for Motor Drive Sheave
10	11779	Belt Guide Clip
11	13414	Main Drive Belt
12	14375	Drive Belt Guard Assembly
13	14359	Drive Belt Guard Support Assembly (Front)
14	71935	Engine Mounting Channel (2 Used)

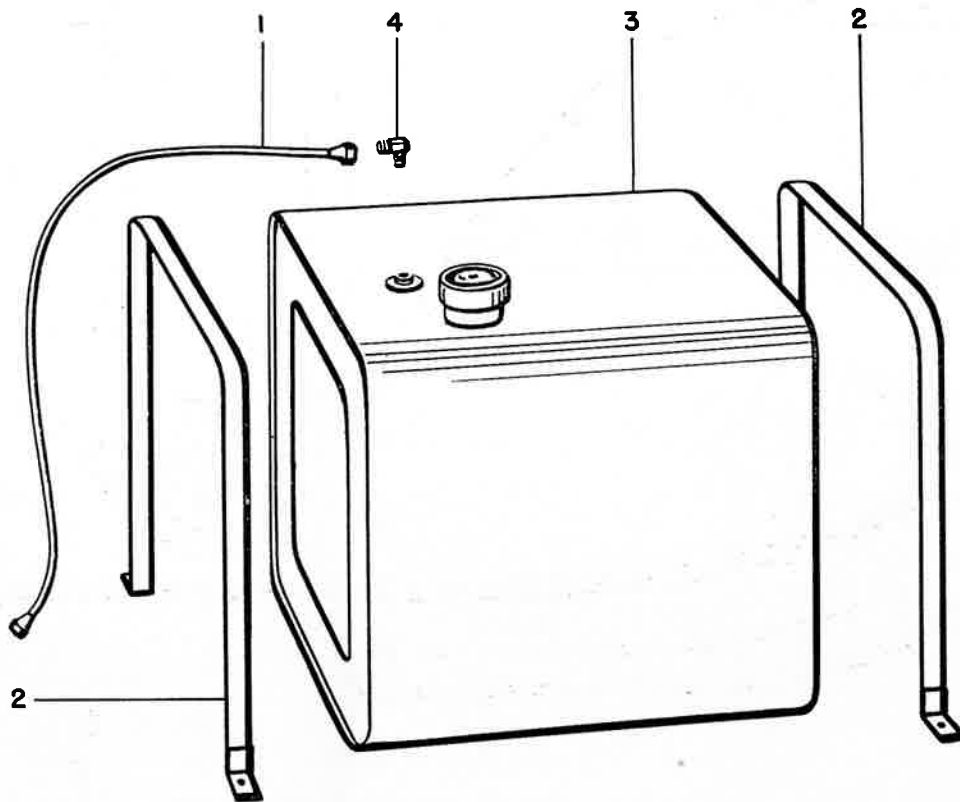

GASOLINE LINE AND TANK

Ref. No.	Part No.	Description
1	13850	Gasoline Line Assembly
2	13879	Holddown strap for Gasoline Tank (2 Used)
3	13420	Gasoline Tank
4	13848	Elbow (Line to Tank)
5	13885	Felt Strap for Gasoline Tank (2 Used) (Not shown)
	11679	Wisconsin VE-4 Engine (Not shown) including: Fuel Pump Oil Bath Air Cleaner Magneto Carburetor Starting Crank Air Intake Screen Mounting Channels

NOTE: 11788 Motor Drive Sheave not included.

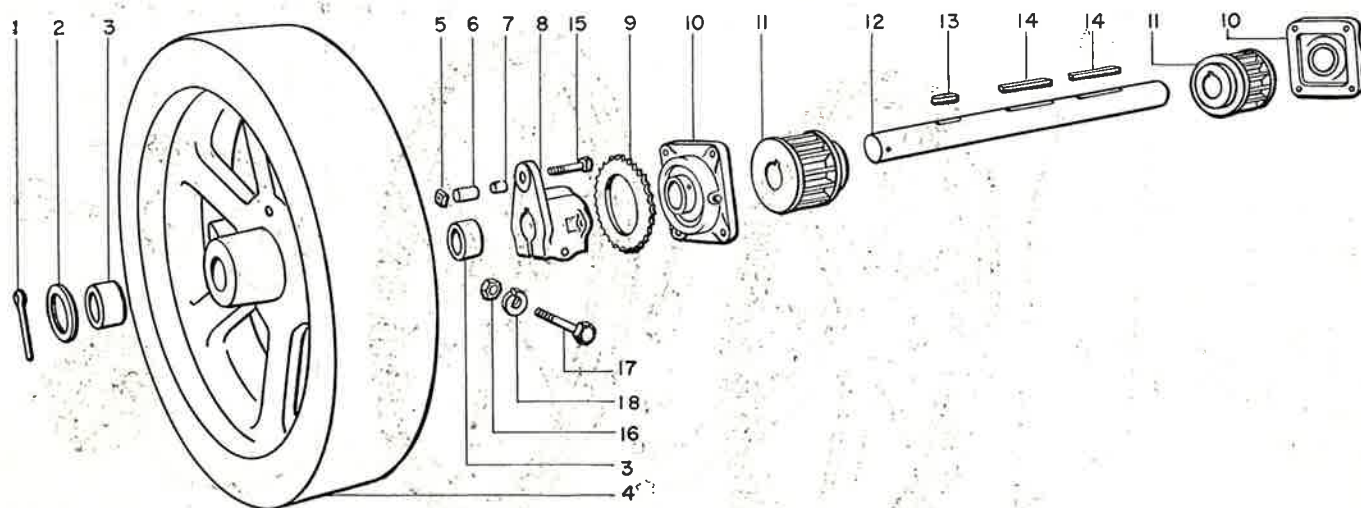

FLYWHEEL, PINION SHAFT, PINION GEARS

Ref. No.	Part No.	Description
1		Cotter Key
2	11622	Flywheel Retaining Washer
3	11624	Flywheel Bushing (2 Used)
4	11677	Flywheel (bushing included)
5		7/16" Square Nut
6	12117	Flywheel Safety Bolt Sleeve
7	12119	Safety Bolt Sleeve for Overload Safety Hub
8	11607	Overload Safety Hub
9	11625	Pick-up Drive Sprocket
10	H823	Flange Bearing (2 Used)
11	Z47A	Main Drive Pinions (2 Used)
12	11621	Pinion Shaft
13	13353	Overload Safety Hub Key
14	H598	Pinion Tapered Keys (2 Used)
15	13803	Special Safety Shear Bolt $7/16 \times 2 \frac{3}{4}$
16		$5/8$ " Hex Head Nut (18 N.F.)
17		$5/8$ " x 4" Hex Head Cap Screw (18 N. F.)
18		$5/8$ " Lock Washer

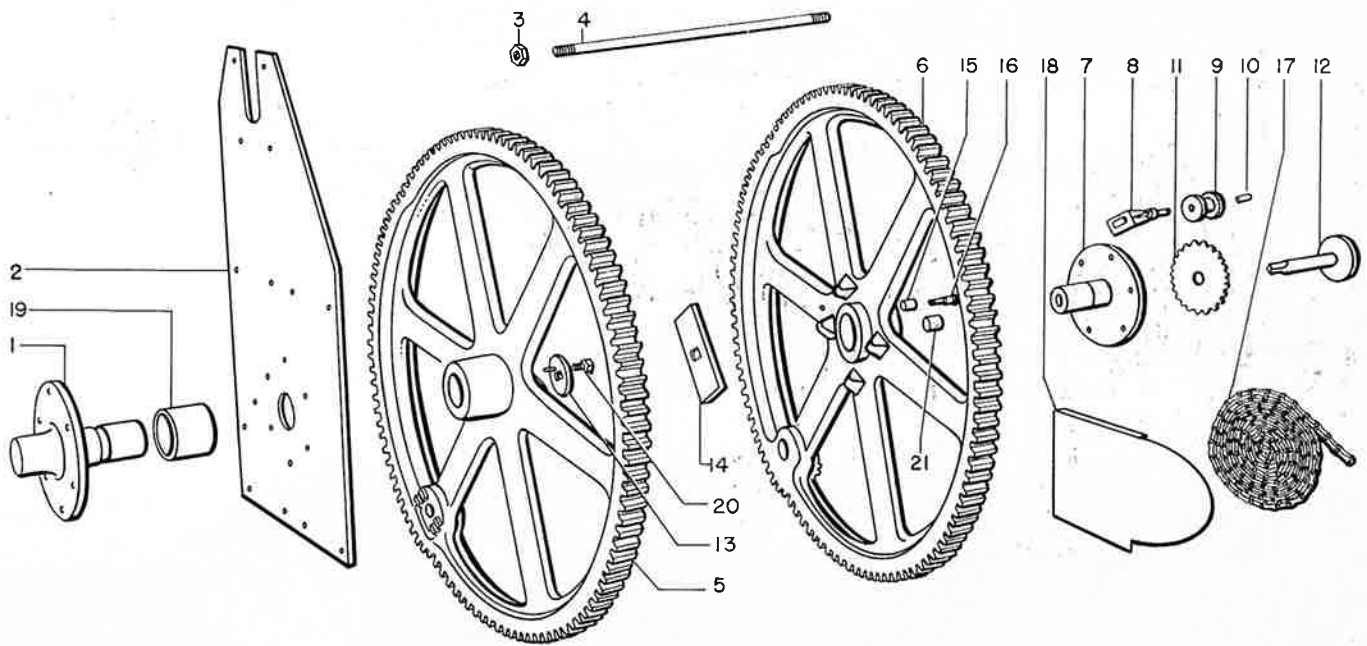

MAIN DRIVE GEARS — MAIN DRIVE GEAR BEARING FLANGE

Ref. No.	Part No.	Description
1	13900	Main Drive Flange Assembly (Right)
2	H178A	Main Drive Side Plate (2 Used)
3		5/8" N. C. Hex Head Nuts
4	H1064	Space Bolt for Main Drive Side Plates
5	Z48R	Main Drive Gear
6	Z48L	Main Drive Gear
7	13899	Main Drive Gear Flange Assembly (Left)
8	Z141	Knotter Chain Idler Bracket
9	Z29	Roller Chain Idler with Bushing
10	1847A1	Wood Bushing for Z29
11	11674	33 Tooth Roller Chain Sprocket (knotter drive)
12	13896	Knotter Drive Shaft
13	H441	Main Drive Gear Retaining Washer
14	H484	Knotter Drive Shaft Plate
15	H8	Roller for Stud on Main Drive Gear Spoke
16	H758	Roller Stud for Push Lever Assembly
17	13394	Knotter Drive Chain (R. C. 550 130 Pitches)
18	13845	Knotter Drive Chain Guard
19	1218A1	Main Drive Gear Bushing (for rebored gears only)
20		5/8" Cap Screw
21	H151	Bushing for Knotter Drive Shaft (2 Used)
	25193	Connecting Link R. C. 550 Extended Pitch (1 Used)
	1194A1	R. C. 50 Offset Link

CONNECTING ROD AND PLUNGER

Ref. No.	Part No.	Description
1	H828	Bronze Bushing, Crank Pin Bearing (2 Used)
2	H439	Crank Pin
3	H958	Crank Pin Bearing and Shaft Ass'y. for Conn. Rod
4	H95	Latch "U" Bolt
5	H850	Latch Clip for "U" Bolt
6	13406	Connecting Rod Tube Assembly
7	13412	Feed Arm Link Bushing (2 Used)
8	13413	Feed Arm Link Assembly
9	H180	Compression Spring
10	H671	Nut Feed Arm Link Pipe (2 Used)
11	13422	Plunger
12	12744	Slicing Knife
13	H903	Spacer Shim, Plunger Shear Plate
14	1122H-1	Flat Head Cap Screw
15	H79	Connecting Rod Roller Pin Assembly
16	H4	Connecting Rod Roller
17	H380	Connecting Rod Latch
18	H52	Connecting Rod Spring Plate
19	H22A	Inside Connecting Rod Latch Spring (2 Used)
20	H21A	Outside Connecting Rod Latch Spring (2 Used)
21	Z163	Connecting Rod Latch Spring Cap (2 Used)
22	Z200	Adjusting Clamp for Connecting Rod
23	H98	Connecting Rod Latch Pin
24		½" Hex Head Cap Screw (20 N. F.)
25	13425	Connecting Rod Assembly Complete
26	13409	Feed Arm Link Pin
27		⅜" Square Head Set Screw
28		⅜" Diameter Jam Nut
29	H830	Rear Plunger Pin
30	H1075	Plunger Pin Bearing (2 Used)
31	H396A	Plunger Stop Front
32	H749	Plunger Stop Outside
33	H859	Top Plunger Wear Plate (4 Used)
34	H902	Spacer Shim, Top Plunger Wear Plate
35	H754	Steel Backing Plate, Bottom Wear Plate
36	H755	Lining, Bottom Wear Plate (4 Used)
37	H812	16 Ga. Plunger Shim
38	H813	20 Ga. Plunger Shim
39	H814	30 Ga. Plunger Shim
40	H751	Plunger Slide Angle (2 Used)

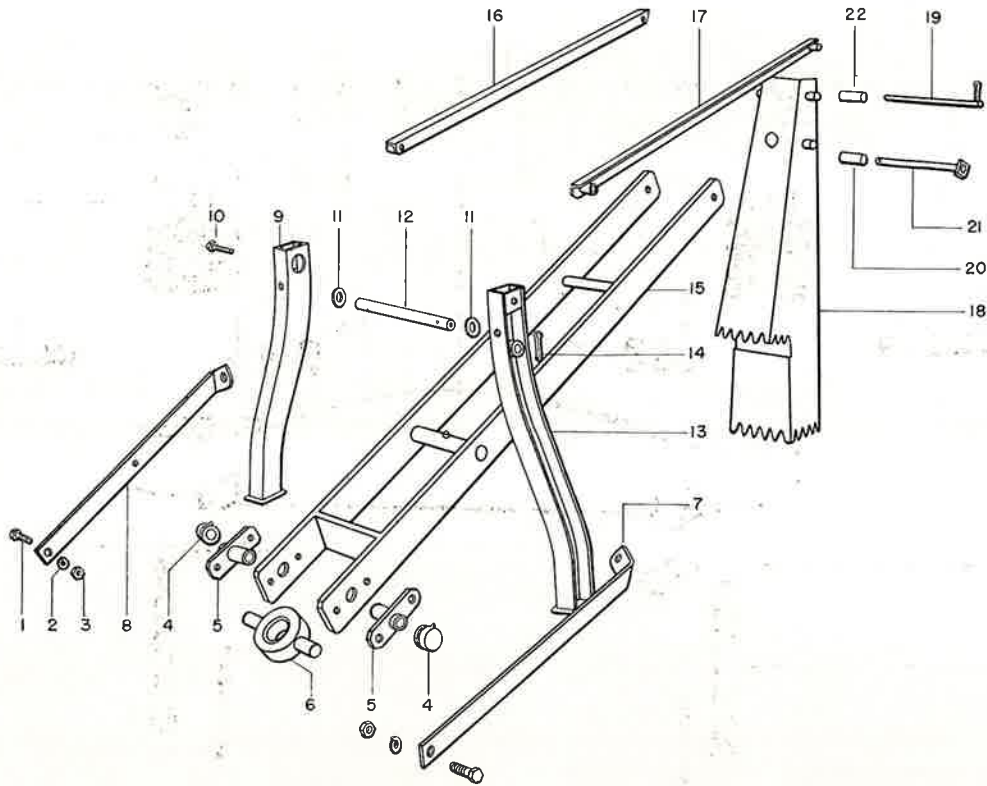

WADBOARD, WADBOARD BRACE POST AND WADBOARD LINKAGE

Ref. No.	Part No.	Description
1	H752	Eccentric Bolt, Feed Arm Post Brace
2		5/8" Lock Washer
3		5/8" Jam Nut
4	1180A1	Pipe Cap
5	H136	Feed Arm Yoke Bearing (2 Used)
6	Z72	Feed Arm Yoke
7	H1003L	Brace (Left) Feed Arm Post
8	H1003R	Brace (Right) Feed Arm Post
9	H1077	Feed Arm Post (Right)
10	1807A1	Hex Wad Board Brace Bearing Bolt (2 Used)
11	H651	Spacer Washer
12	H1006	Feed Arm Pin
13	H409L	Feed Arm Post (Left)
14		Cotter Pin
15	H562	Feed Arm
16	H860	Wad Board Brace (Right)
17	H853	Wad Board Brace (Left)
18	11797	Wad Board
19	13427	Wad Board Brace Pin
20	13350	Bronze Bushing (2 Used)
21	H145	Wad Board Pin
22	12239	Bronze Bushing (2 Used)

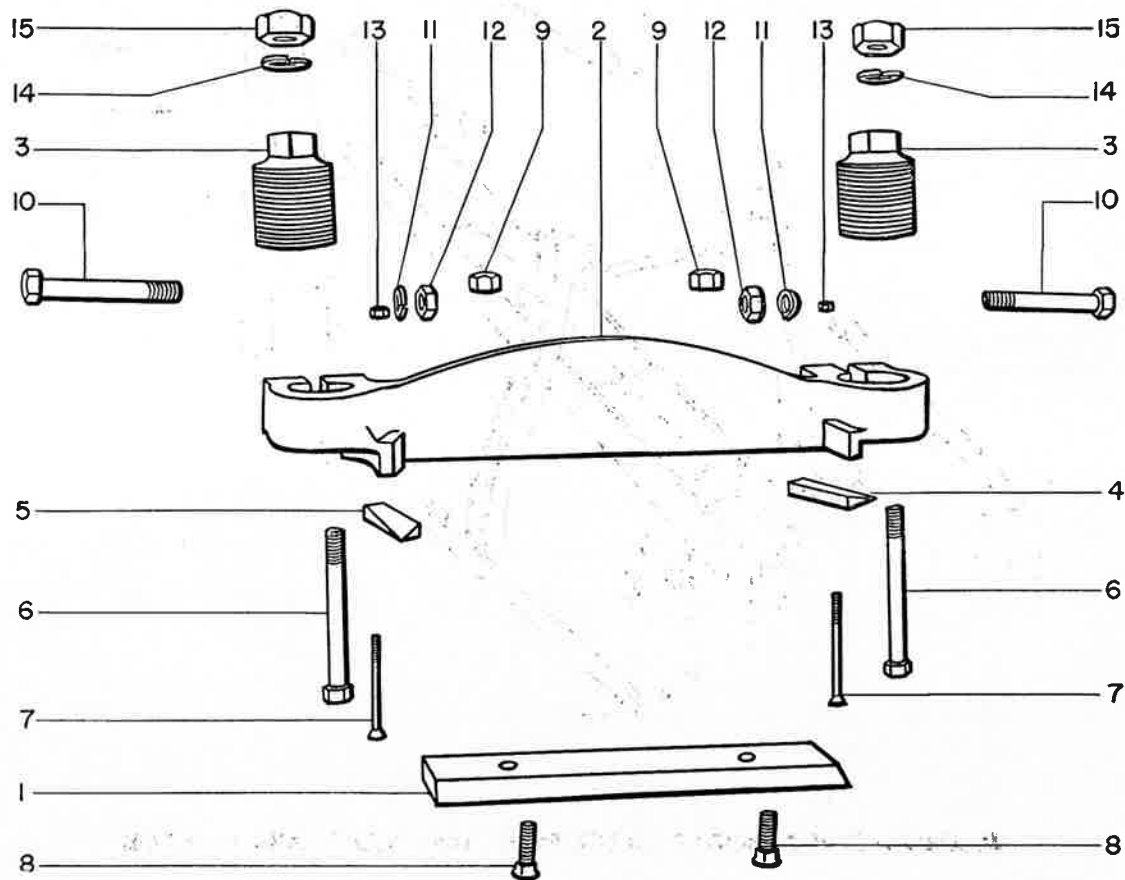

STATIONARY KNIFE HOLDER

Ref. No.	Part No.	Description
1	12786	Stationary Knife
2	11536	Stationary Knife Bracket
3	12793	Knife Bracket Adjusting Screw (2 Used)
4	12195	Knife Bracket Wear Plate (Right)
5	12194	Knife Bracket Wear Plate (Left)
6		3/4" x 4 1/2" Hex Head Cap Screw
7		5/16" x 3 1/2" Flat H. D. Stove Bolt
8		5/8" x 2 1/8" Plow Bolt No. 3
9		5/8" Hex Nut
10		5/8" x 4" Cap Screw Hex H. D.
11		5/8" Lock Washer
12		5/8" Hex H. D. Nut
13		5/16" Hex Nut
14		3/4" Lock Washer
15		3/4" Hex Nut

PICK-UP ASSEMBLY

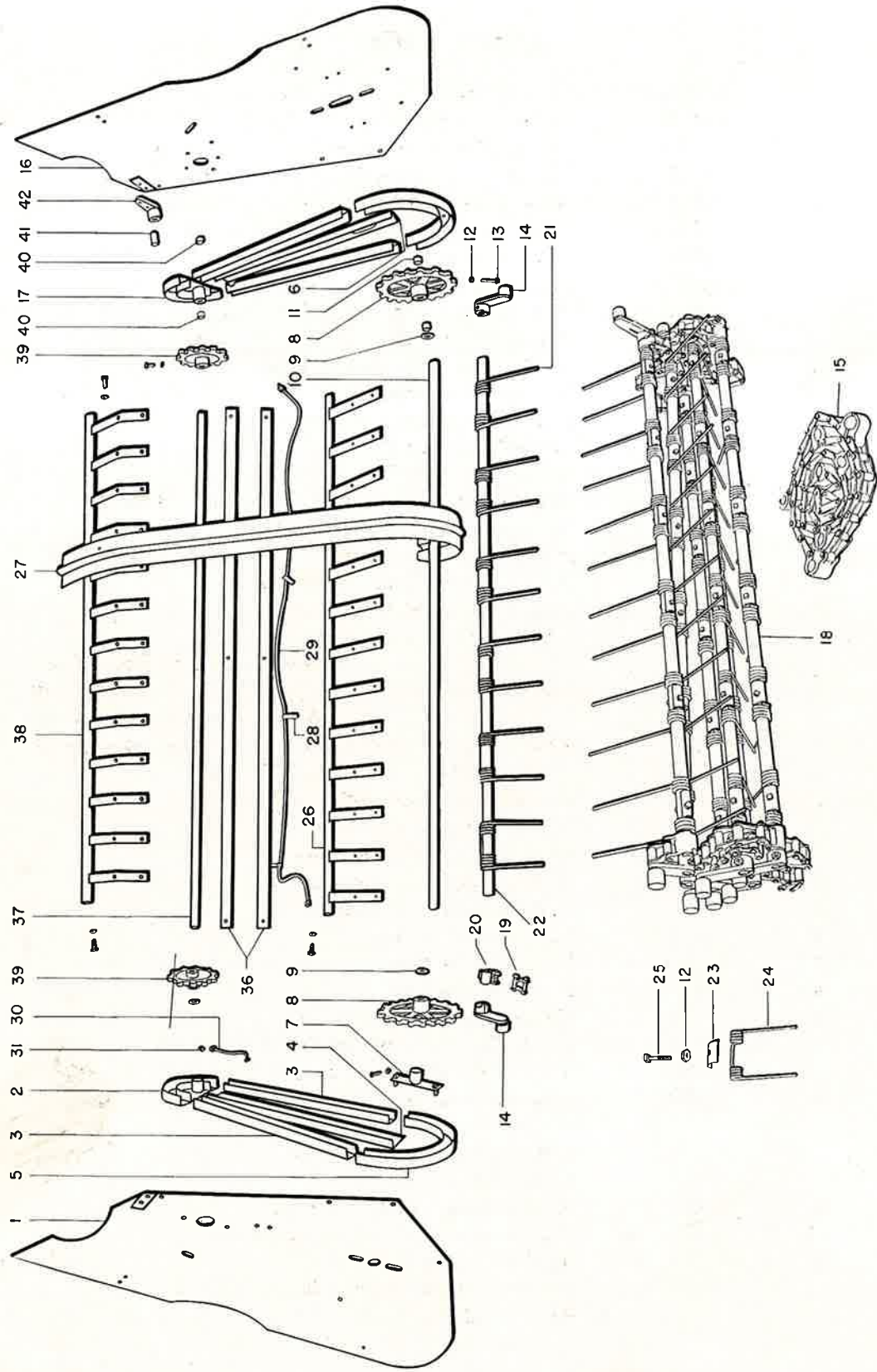

PICK-UP ASSEMBLY

Ref. No.	Part No.	Description
	25083	Pick-up Complete
1	14365	Pick-up Side Plate (Right)
2	13370	Pick-up Finger Cam Bearing Assembly (Right)
3	13357	Pick-up Cam Trough (4 Used)
4	12035	Pick-up Side Reinforcing Angle (Right)
5	13356	Pick-up Cam (2 Used)
6	12071	Pick-up Side Reinforcing Angle (Left)
7	11676	Pick-up Chain Adjusting Plate Assy. (2 Used)
8	12791	Pick-up Chain Idler Sprocket (2 Used)
9	H-651	11 Ga. Space Washer (4 Used)
10	11673	Pick-up Chain Idler Shaft
11	H-960	Bronze Bushings (4 Used)
12		3/8" Self-Locking Nut
13		3/8" x 2" Square Head Machine Bolt
14	12029	Pick-up Finger Cam Roller Assembly (14 Used)
15	12024	Pick-up Chain Assembly (2 Used)
16	14364	Pick-up Side Plate (Left)
17	13371	Pick-up Finger Cam Bearing (Left)
18	13991	Pick-up Chain and Pipe Assembly
19	25605	445 Single Link Pintle Chain (With 2 Pins and Cotter Keys)
20	25604	Special Attaching Link for 445 Pintle Chain (14 Used) (With 2 Pins and Cotter Keys)
21	13521	Pick-up Finger Pipe—with fingers attached (7 Used)
22	12025	Pick-up Finger Pipe (Only) (7 Used)
23	12026	Pick-up Finger Clip (42 Used)
24	12027	Pick-up Fingers (42 Used)
25		3/8" x 1 1/4" Square Machine Bolt
26	11760	Pick-up Guard Support (Lower)
27	12017	Pick-up Guard (13 Used)
28	13510	Tube Clip (4 Used)
29	13509	Long Grease Line
30	13508	Short Grease Line
31	11787	Compression Fitting (2 Used)
32	13367	Brass Nut for 3/16" Tubing (2 Used)
33	13362	3/16" O. D. Copper Tubing Sleeve (2 Used)
34	11784	Tube Connection (2 Used)
35		3/8" Jam Nut, Tube Connection
36	12036	Pick-up Cross Brace (2 Used)
37	11678	Pick-up Drive Shaft
38	12014	Pick-up Guard Support (Upper)
39	12004	Pick-up Chain Drive Sprocket (2 Used)
40	13364	Bronze Bushing (4 Used)
41	12081	Pick-up Hanger Bearing Sleeve (2 Used)
42	12070	Pick-up Hanger Bearing (2 Used)

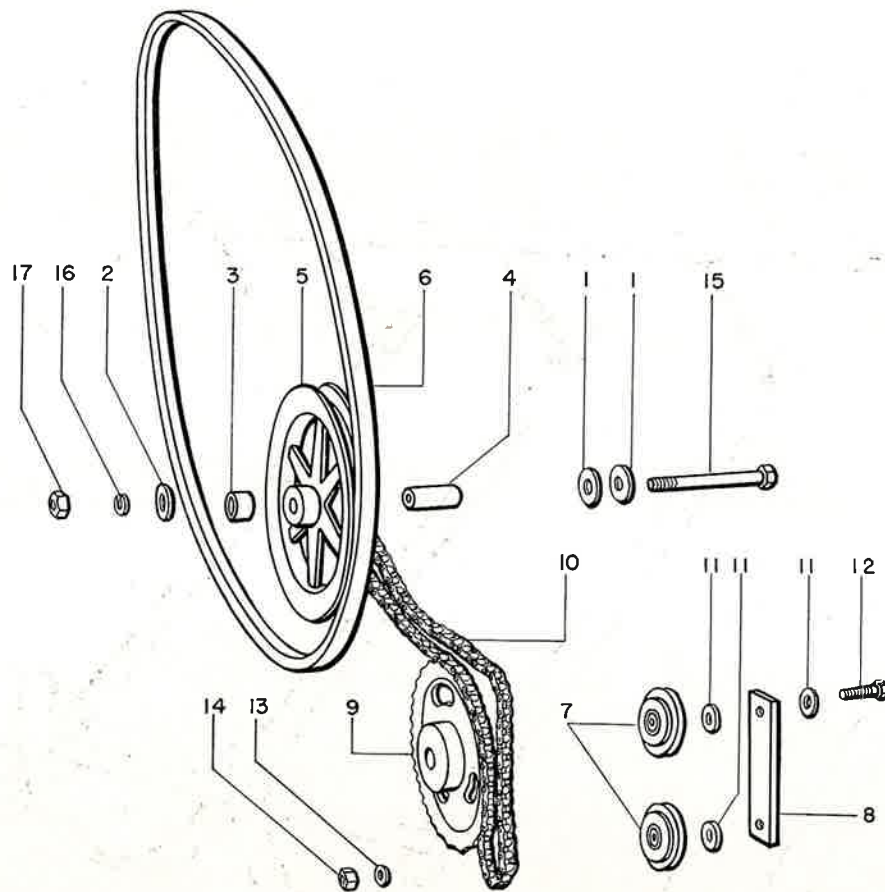

AUGER, AND PICK-UP DRIVEN ASSEMBLY

Ref. No.	Part No.	Description
1	H651	Spacer Washer
2		5/8" Flat Washer
3	13355	Needle Bearing for Part No. 11780 (2 Used)
4	11747	Hanger Bolt Sleeve
5	11780	Combination Pick-up Driven V Belt Sheave and Roller Chain Sprocket
6	13416	Auger Pick-up and Feed Roll Drive Belt
7	13550	Chain Idler Assembly
8	13372	Pick-up Chain Idler Bar
9	11722	Pick-up Driven Sprocket
10	13424	Pick-up Drive Chain (R. C. 40 124 Pitches)
11		1/2" Flat Washer (3 Used)
12		1/2" x 2" Hex Head Machine Bolt
13		1/2" Lock Washer
14		1/2" Hex Head Nut
15		5/8" x 6 1/4" Pick-up Mounting Bolt
16		5/8" Lock Washer
17		5/8" Nut

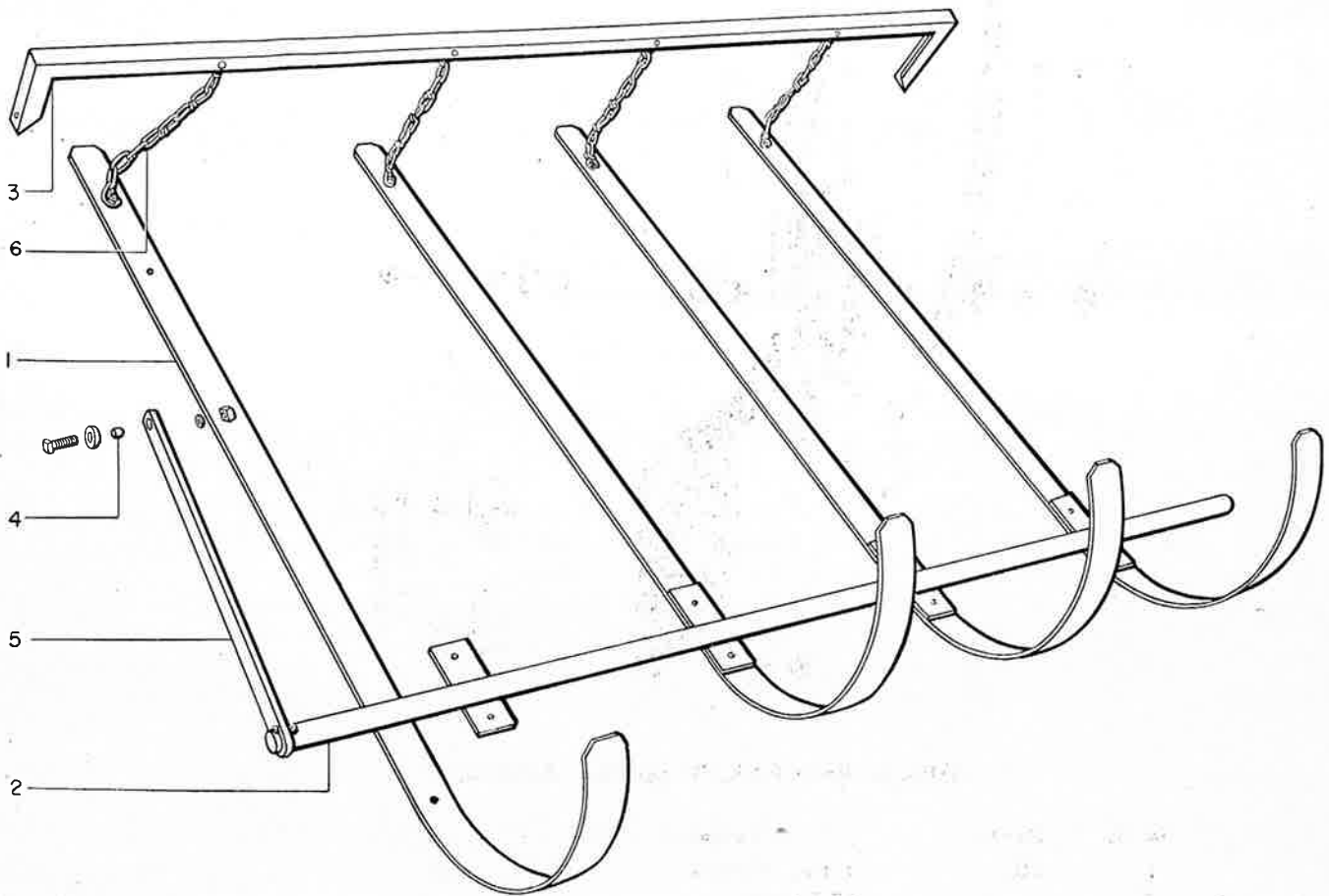

PICK-UP WINDGUARD ASSEMBLY

Ref. No.	Part No.	Description
1	12785	Pick-up Windguard Assembly (4 Used)
2	12790	Pick-up Windguard Support Pipe Assembly
3	12045	Pick-up Windguard Holder
4	11555	Spacer Bushing (2 Used)
5	12043	Windguard Pipe Clip (2 Used)
6	12046	Pick-up Windguard Chain (4 Used)

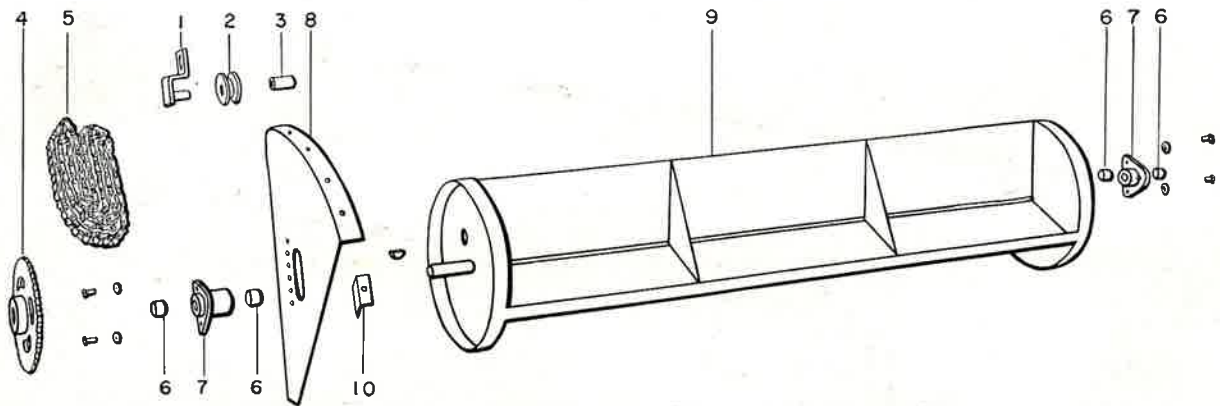

FEED ROLL ASSEMBLY

Ref. No.	Part No.	Description
1	13386	Feed Roll Drive Idler Support Assembly
2	Z29	Roller Chain Idler Roller with Bushing
3	1847A1	Wood Bushing for Z-29 Idler
4	11722	Feed Roll Drive Sprocket
5	13393	Feed Roll Drive Chain (R. C. 40 96 Pitches)
6	H960	Bronze Bushing Feed Roll Bearing (4 Used)
7	11750	Feed Roll Bearing (2 Used)
8	13403	Feed Roll Bearing Plate (Right)
9	11757	Feed Roll
10	25230	Pick-up Side Plate Guide (2 Used)

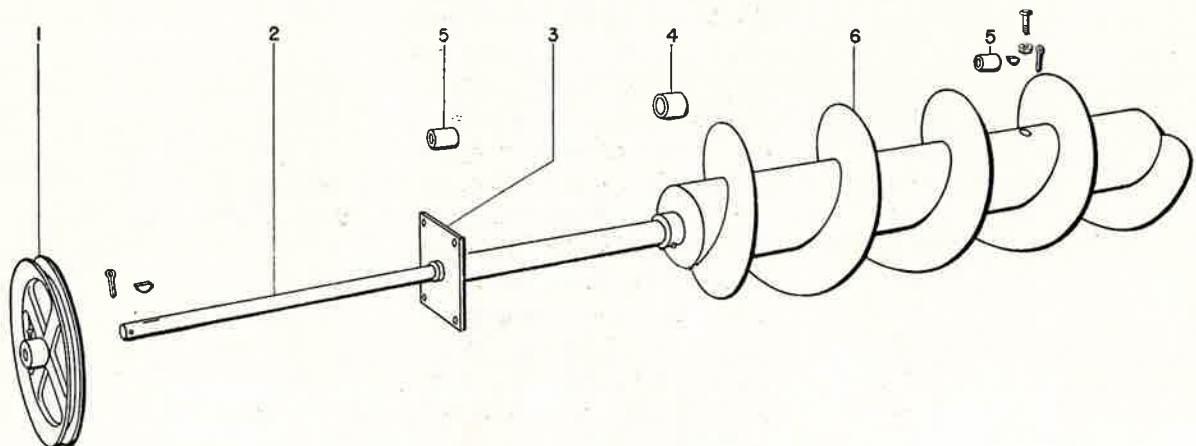

AUGER ASSEMBLY

Ref. No.	Part No.	Description
1	11732	Combination Auger Driven Sheave and Feed Roll Chain Drive Sprocket
2	11710	Auger Drive Shaft 47 5/16"
3	11737	Auger Bearing Tube
4	11738	Auger Bearing Tube Bronze Bushing (2 Used)
5	11739	Auger Bearing Bushing
6	11758	Auger

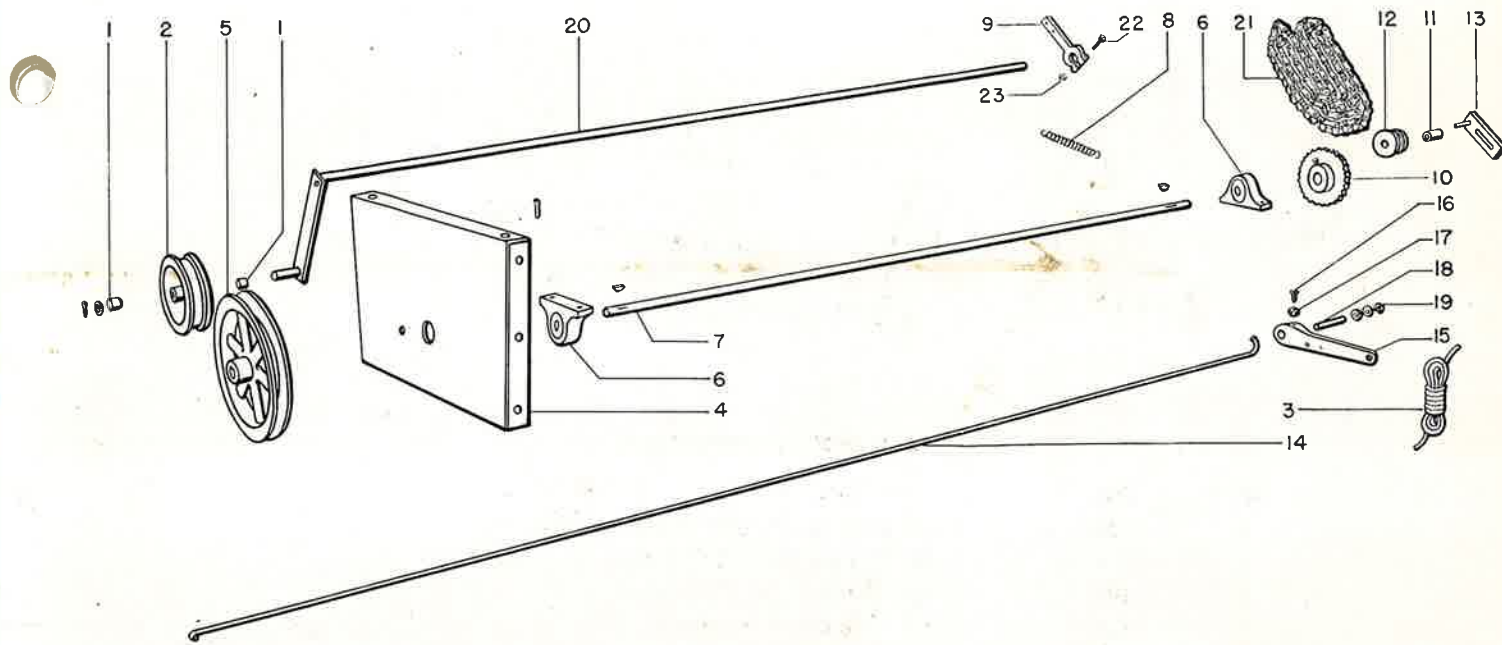

FEEDER AND PICK-UP DRIVE

Ref. No.	Part No.	Description
1	H1070	Bronze Bushing for Z223 Tightener (2 Used)
2	Z223	Pick-up Feed Roll Belt Tightener
3	13992	Pick-up Drive Release Rope
4	11721	Feeder Bearing Support Plate
5	Z222	Pick-up Auger, Driven Sheave
6	13373	Pillow Block Bearing (2 Used)
7	11720	Pick-up, Auger Drive Shaft
8	H12	Belt Tightener Tension Spring
9	14031	Pick-up, Auger Belt Tightener Adjuster
10	11734	Pick-up Auger Driven Sprocket (29 tooth— $\frac{5}{8}$ " pitch)
11	1847A1	Wood Bushing for Z29 Idler
12	Z29	Roller Chain Idler Roller with Bushing
13	12715	Chain Tightener Assembly
14	11781	Feeder Belt Tightener Rod
15	14001	Belt Tightener Release Lever
16		$\frac{5}{16}$ " Hollow Head Half Dog Point Set Screw
17		$\frac{5}{16}$ " Jam Nut
18	13662	Belt Tightener Release Bearing
19		$\frac{5}{8}$ " Hex Nut
20	11716	Auger Belt Tightener Assembly
21	13395	Pick-up and Feeder Drive Chain (R. C. 550 107 Pitches)
22		$\frac{3}{8}$ " x 2" Cap Screw
23		$\frac{3}{8}$ " Hex Nut
	25193	Connecting Link, R. C. 50 Extended Pitch (2 Used) (Not Shown)
	1194A1	R. C. 50 Connecting Link (Not Shown)

PICK-UP LIFT, GROUND WHEELS, FEEDER SUPPORTS

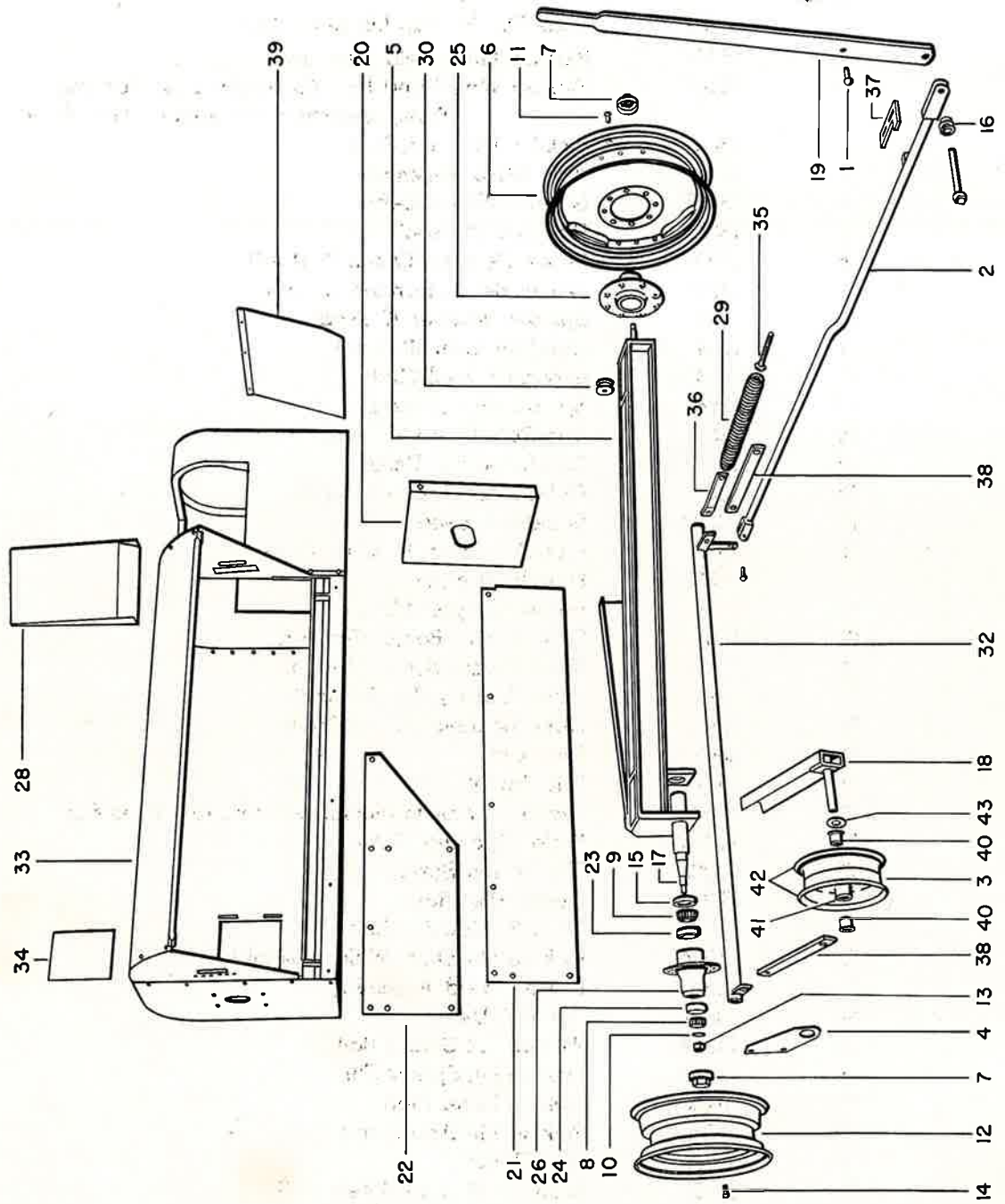

PICK-UP LIFT, GROUND WHEELS, FEEDER SUPPORTS

Ref. No.	Part No.	Description
1	80802	Yoke Pin, Pick-up Lift Lever Link
2	13365	Pick-Up Link Weld Assembly
3	25564	Pick-up Wheel and Hub Assembly (Less Tire and Tube, consisting of Reference Nos. 41, 42)
4	13525	Pick-Up Lift Shaft Support
5	13536	Axle Weld Assembly
6	13537	Ground Wheel (Left)
7	13960	Hub Cap (2 Used)
8	13539	Wheel Bearing (Outer) (2 Used)
9	13540	Wheel Bearing (Inner) (2 Used)
10	13541	Spindle Washer (2 Used)
11	13542	Hub Bolt (Left) (8 Used)
12	13545	Ground Wheel (Right)
13	13967	Spindle Nut (2 Used)
14	13547	Hub Bolt (Right) (6 Used)
15	13548	Grease Seal (2 Used)
16	13555	Pick-Up Lift Spring Handle
17	13733	Spindle (2 Used)
18	13775	Axle Assembly Pick-Up Wheel
19	11682	Pick-Up Handle
20	14352	Feeder Support Plate
21	13574	Long Feeder Bottom Support
22	13549	Short Feeder Bottom Support
23	13958	Inner Bearing Cup (2 Used)
24	13957	Outer Bearing Cup (2 Used)
25	25057	Hub (Left)
26	25110	Hub (Right)
27	13891	Feeder Complete Including Auger and Feed Roll
28	11776	Knife Opening Cover
29	25392	Pick-up Lift Spring
30	Z29	Chain Idler Roller
31		5/8" x 5" Machine Bolt
32	11694	Pick-up Lift Shaft Weld Assembly
33	13513	Feeder Weld Assembly
34	13852	Cover (2 Used)
35	14363	Pick-up Lift Spring Bolt
36	14356	Pick-up Lift Spring Clip
37	14163	Pick-up Lever Stop
38	14360	Pick-up Lift Arm (Long)
39	11770	Hay Guard
40	25450	Bushing, Pick-up Wheel (2 Used)
41	25452	Hub and Bushing, Pick-up Wheel
42	25451	Wheel Disc (Right and Left) 1 pr., Pick-up Wheel
43	H651	Washer (2 Used)

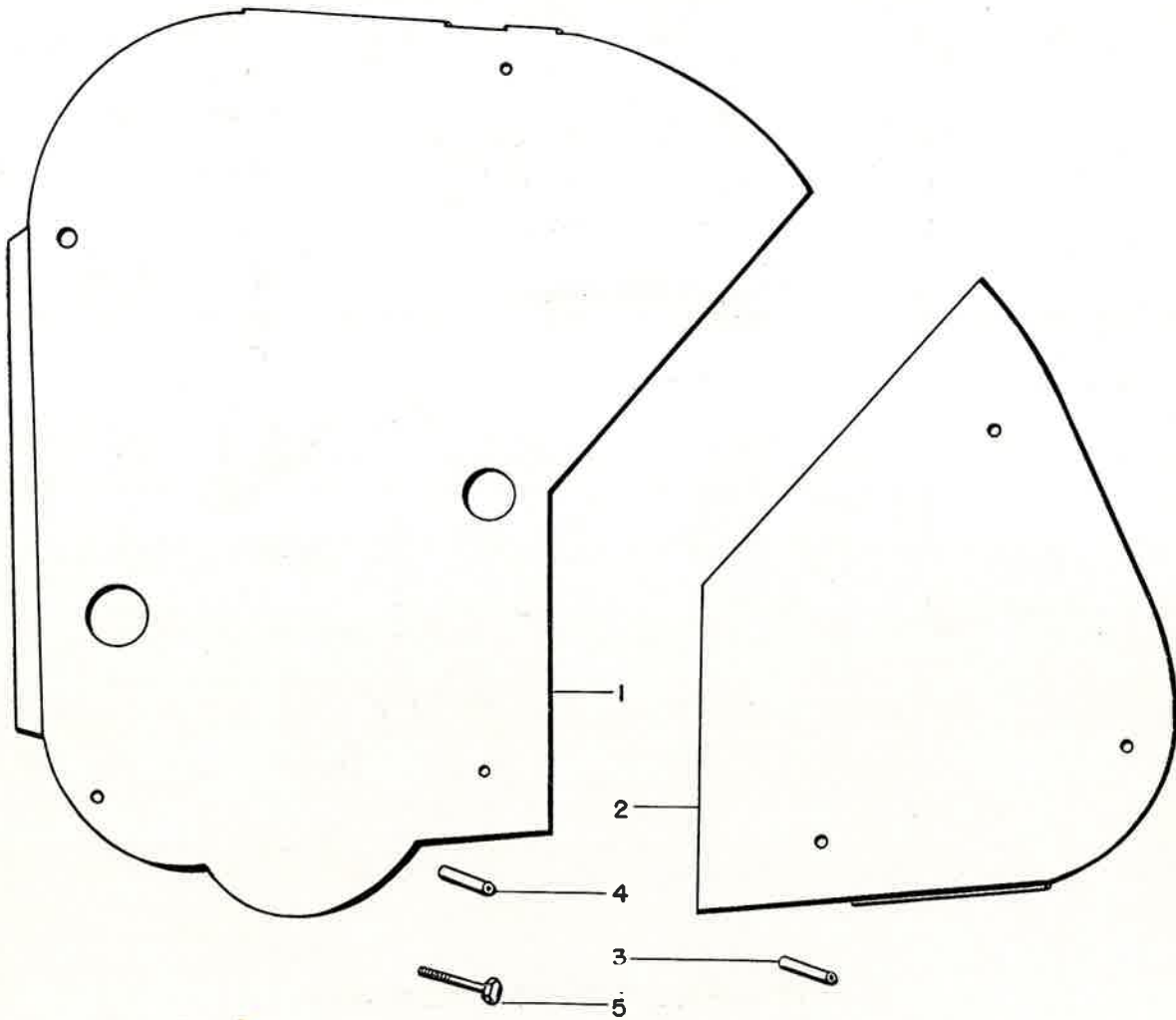

RIGHT SIDE BELT GUARDS

Ref. No.	Part No.	Description
1	14146	Right Side Belt & Chain Guard
2	14147	Right Side Belt & Chain Guard (front)
3	14149	Right Side Chain Guard Spacer (3 Used)
4	14148	Right Side Belt Guard Spacer (4 Used)
5		Belt Guard Bolt.

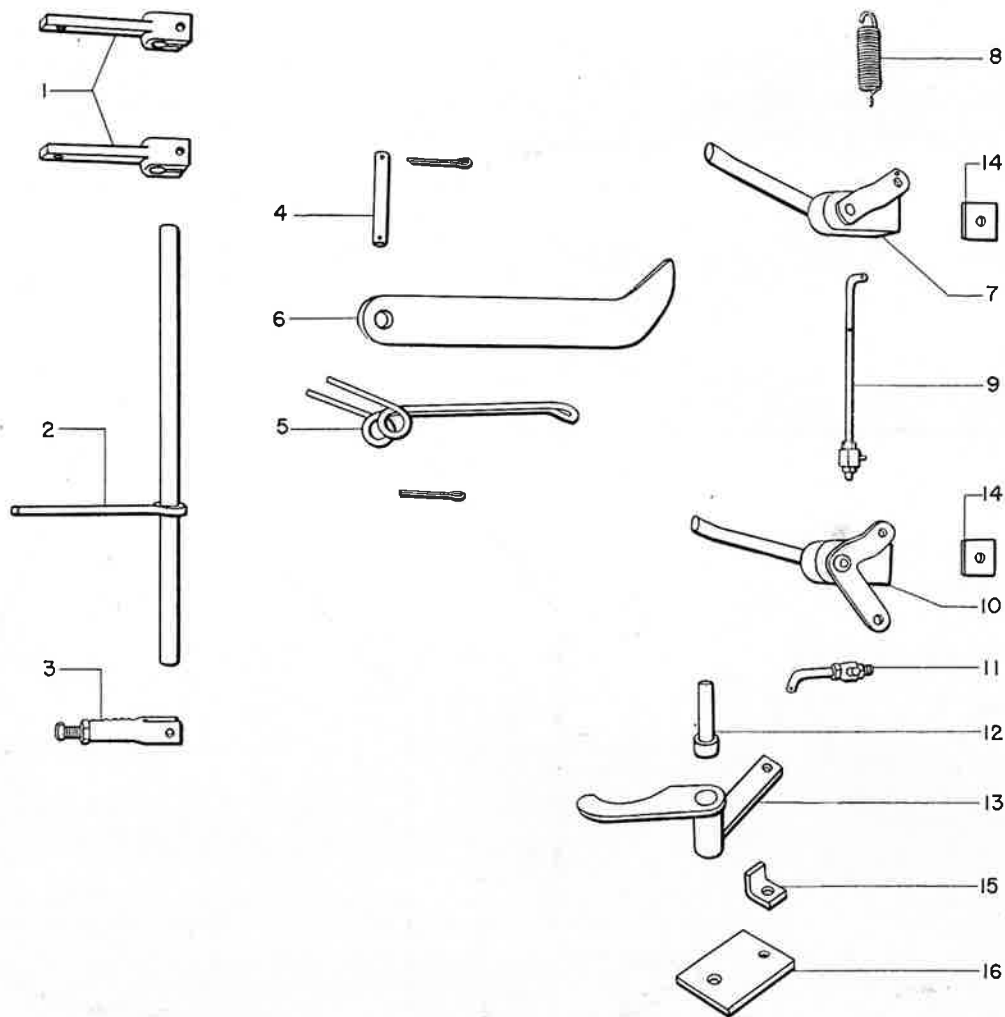

KNOTTER TRIP SHAFT, TWINE FINGERS, DOGS

Ref. No.	Part No.	Description
1	11561	Knotter Trip Shaft Lever (2 Used)
2	11564	Knotter Trip Shaft
3	H1002	Knotter Stop for Trip Shaft
4	H56	Dog Pin (2 Used)
5	H1	Dog Spring (2 Used)
6	Z118	Dog (2 Used)
7	H808A	Twine Finger Lever Assembly
8	H16	Twine Finger Return Spring
9	H505	Long Twine Finger Link
10	H809A	Twine Finger Double Lever Assembly
11	H497	Short Twine Finger Link
12	11597	Spacer Bushing
13	11599	Twine Finger Lever
14	11868	Shim, Twine Finger Bracket (2 Used)
15	11600	Twine Finger Stop
16	11575	Twine Finger Lever Base

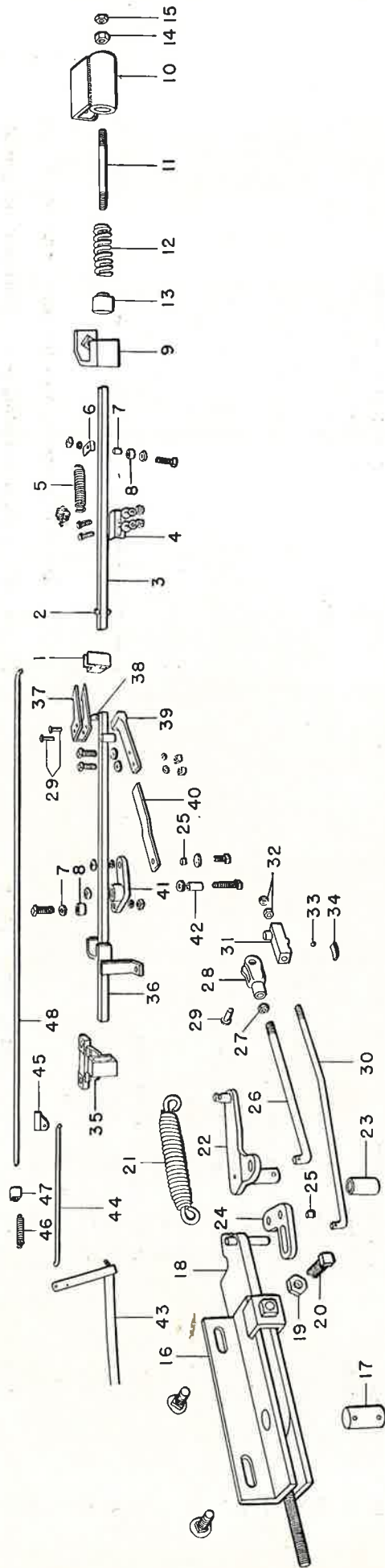

OVER-CENTER ASSEMBLY — FRONT TRIP ROD AND TRIP ROD RETURN LINK ASSEMBLY

Ref. No.	Part No.	Description	Ref. No.	Part No.	Description
1	11569	Intermediate Trip Rod Guide	35	11546	Front Trip Rod Guide
2	12579	Type E Driv-Lok Pin 3/8" x 1 1/4"	36	11568	Front Trip Rod Weld Assembly
3	12605	Rear Trip Rod	37	12789	Trip Rod Connector
4	H15	Push Rod Pawl	38	H25	Trip Rod Connector Reset Spring
5	11578	Rear Trip Rod Return Spring	39	11572	Trip Rod Return Link
6	11574	Trip Rod Spring Clip	40	11577	Trip Rod Return Link (Slotted)
7	12595	Spacer Bushing			
8	11567	Cam Follower			
9		Rear Trip Rod Guide			
10	11792	Shock Absorber Housing			

11 $\frac{3}{8}$ " x $\frac{3}{4}$ " N. C. Hex Head M. B.
 12 Shock Absorber Spring
 13 Spring Seat
 14 $\frac{3}{8}$ " N. C. Full Nut
 15 $\frac{3}{8}$ " N. C. Jam Nut

H22
 11794

OVER-CENTER ASSEMBLY — TRIP ROD RETURN LEVER ASSEMBLY

Ref. No.	Part No.	Description
41	11592	Trip Rod Return Lever
42	11594	Spacer Bushing

OVER-CENTER ASSEMBLY — PUSH ROD LEVER ASSEMBLY

Ref. No.	Part No.	Description
43	11540	Push Rod and Lever Assembly
44	11545	Push Rod Connecting Link
45	11544	Push Rod Attachment
46	H15	Push Rod Return Spring
47	11543	Front Push Rod Guide
48	11553	Push Rod

OVER-CENTER ASSEMBLY — KNOTTER TRIP LEVER LINK ASSEMBLY

Ref. No.	Part No.	Description
16	11542	Plunger Latch Frame
17	H55	Plunger Latch Pin
18	12787	Plunger Latch
19		$\frac{1}{2}$ " Jam Nut
20		$\frac{1}{2}$ " x $\frac{1}{4}$ " Sq. Head Set Screw
21	H13A	Over-Center Latch Spring
22	12571	Over-Center Cam
23	12239	Over-Center Cam Bearing
24	11554	Knotted Trip Lever
25	11555	Spacer Bushing
26	12575	Over-Center Control Rod
27		$\frac{3}{8}$ " N. C. Jam Nut
28	Z168	Trip Rod Clevis
29	12611	Clevis Pin (3 used)
30	11559	Knotted Trip Link
31	12566	Knotted Trip Lever Control Safety Block
32		$\frac{3}{8}$ " Jam Nut N. C.
33	11869	$\frac{1}{4}$ " Chrome Steel Ball
34	12567	Knotted Trip Lever Control Safety Spring

Always be sure to give the serial number of your machine when ordering parts. Always specify name and description as well as part number.

NEEDLE YOKE, NEEDLES, KNOTTER SUPPORT

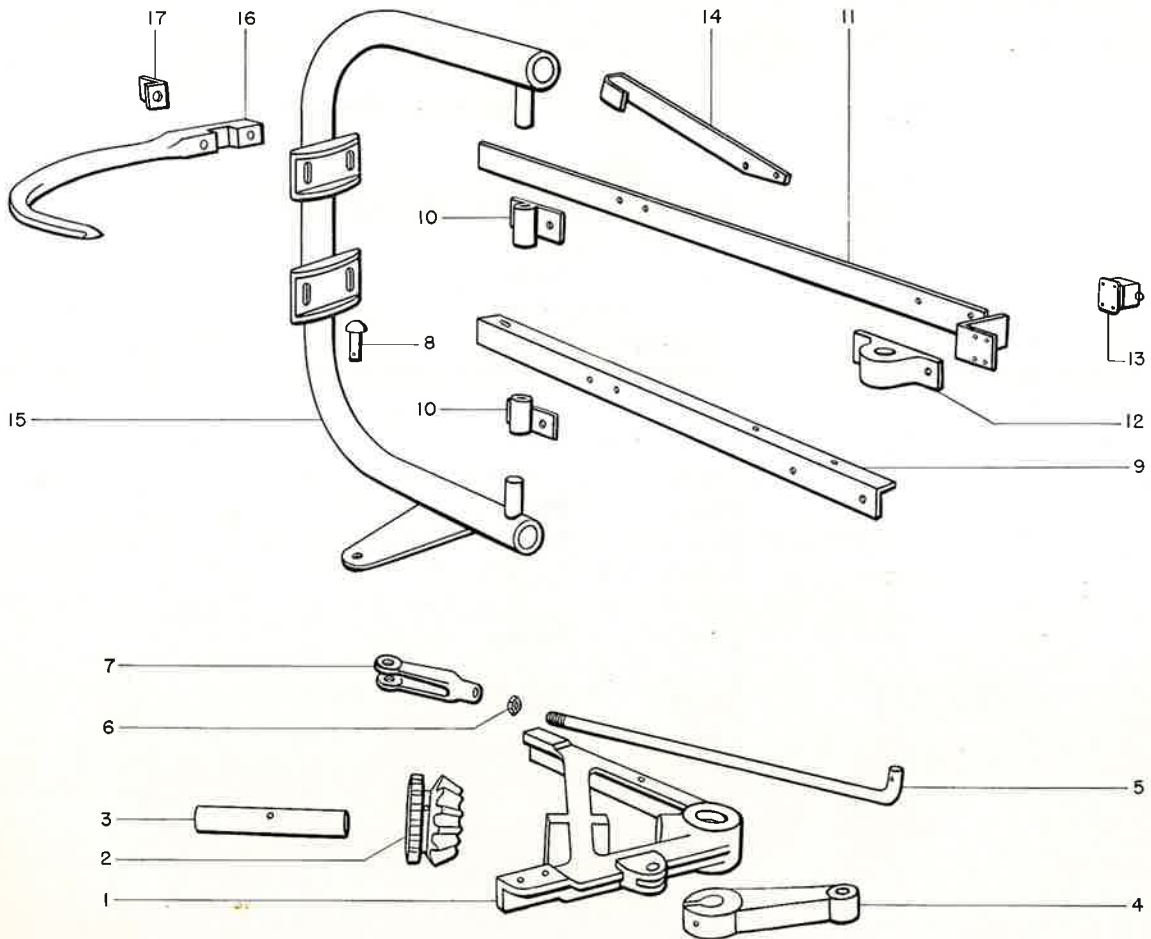

METERING WHEEL ASSEMBLY

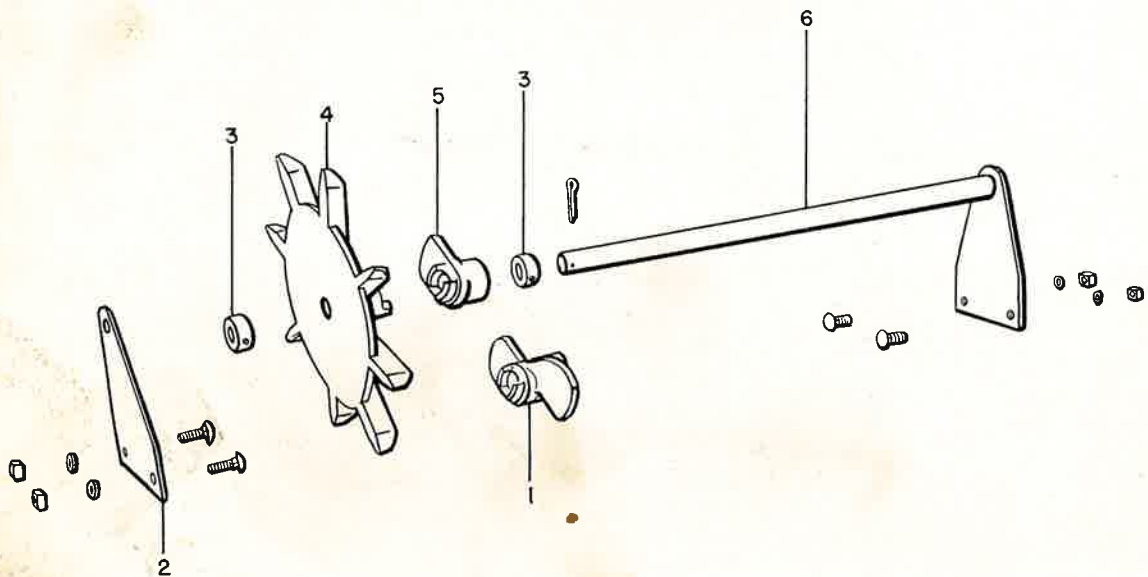

NEEDLE YOKE, NEEDLES, KNOTTER SUPPORT

Ref. No.	Part No.	Description
1	11534	Malleable Knotter Drive Bearing Bracket
2	11532	Knotter Drive Pinion
3	11603	Knotter Idler Shaft
4	13376	Bottom Knotter Arm
5	11552	Needle Yoke Rod
6		5/8" Jam Nut
7	Z150	Clevis
8	11614	Needle Yoke Clevis Pin
9	11586	Knotter Support (Bottom)
10	H81	Needle Yoke Bearing
11	11585	Knotter Support (top)
12	Z64	Knotter Shaft Bearing
13	1185A1	Bale Counter
14	13987	Needle Yoke Spring
15	11550	Needle Yoke
16	Z67	Needle
17	H80	Twine Guide

METERING WHEEL ASSEMBLY

Ref. No.	Part No.	Description
1	14066	Metering cam for 18" Bale
2	12607	Metering Shaft Bracket
3	1182A1	Set Collar (2 Used)
4	12610	Metering Wheel
5	12609	Metering Cam
6	11605	Metering Shaft Assembly

KNOTTER ASSEMBLY

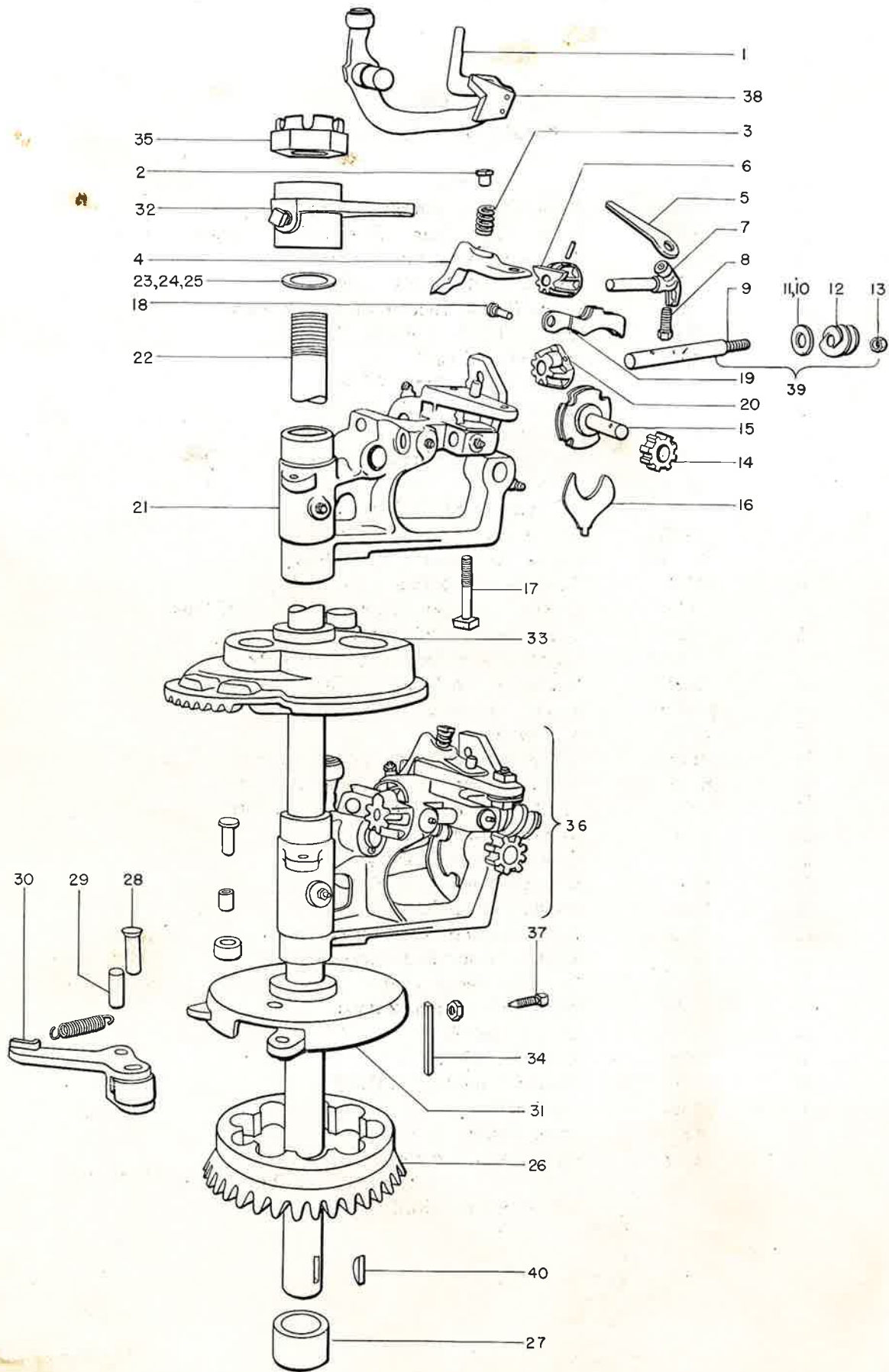

KNOTTER ASSEMBLY

Ref. No.	Part No.	Description
1	1845B91	Knife Arm Assembly (2 Used)
2	1105H1	Knotter Hook Cam Adjusting Nut (2 Used)
3	1104H1	Knotter Cam Spring (2 Used)
4	1102H1	Knotter Hook Cam (2 Used)
5	1109H1	Twine Holder Tension Spring (2 Used)
6	1121H1	Knotter Bill Hook Pinion (2 Used)
7	H40	Bill Hook (2 Used)
8		3/8" x 1" Cap Screw (2 Used)
9	1824A1	Knotter Worm Shaft (2 Used)
10	1158A1	Knotter Worm Washer 22 GA.
11	1117H1	Knotter Worm Washer 16 GA.
12	1841A1	Worm
13		3/8" Hex Nut (24 N. F.)
14	1840A1	Twine Disc Pinion (2 Used)
15	1831A91	Twine Disc Assembly (2 Used)
16	1119H1	Disc Cleaner (2 Used)
17	1103H1	Knotter Hook Cam Adjusting Screw (2 Used)
18	1120H1	Twine Holder Pin (2 Used)
19	1836A91	Twine Holder Assembly (2 Used)
20	1108H1	Knotter Worm Pinion (2 Used)
21	1100H1	Knotter Frame (2 Used)
22	11587	Knotter Shaft
23	H672	22 GA. Knotter Shaft Spacer Washer
24	H673	16 GA. Knotter Shaft Spacer Washer
25	H674	11 GA. Knotter Shaft Spacer Washer
26	11524	Knotter Clutch Gear
27	H131	Knotter Clutch Bushing
28	H128	Knotter Clutch Pawl Pin
29	11529	Knotter Clutch Roller
30	11530	Knotter Clutch Pawl Assembly
31	11531	Knotter Clutch Disc Assembly
32	11588	Trip Rod Return Cam
33	11589	Knotter Cam Gear (2 Used)
34	11695	Clutch Disc Key
35	11789	Knotter Shaft Nut
36	H555	Knotter Complete (2 Used)
37	11582	Set Screw
38	1839A1	Knife, Twine
39	1841B11	Knotter Worm Assembly (Consisting of Ref. Nos. 9, 10, 12, 13)
40		1/4" x 1 1/8" Woodruff Key

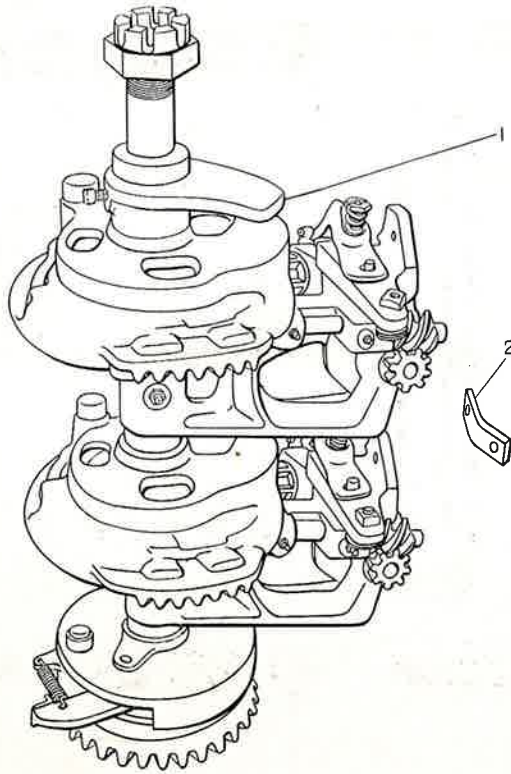

KNOTTER ASSEMBLY COMPLETE

Ref. No.	Part No.	Description
1	11790	Knotter Assembly Complete
2	11602	Knotter Attachment Clip (2 Used)

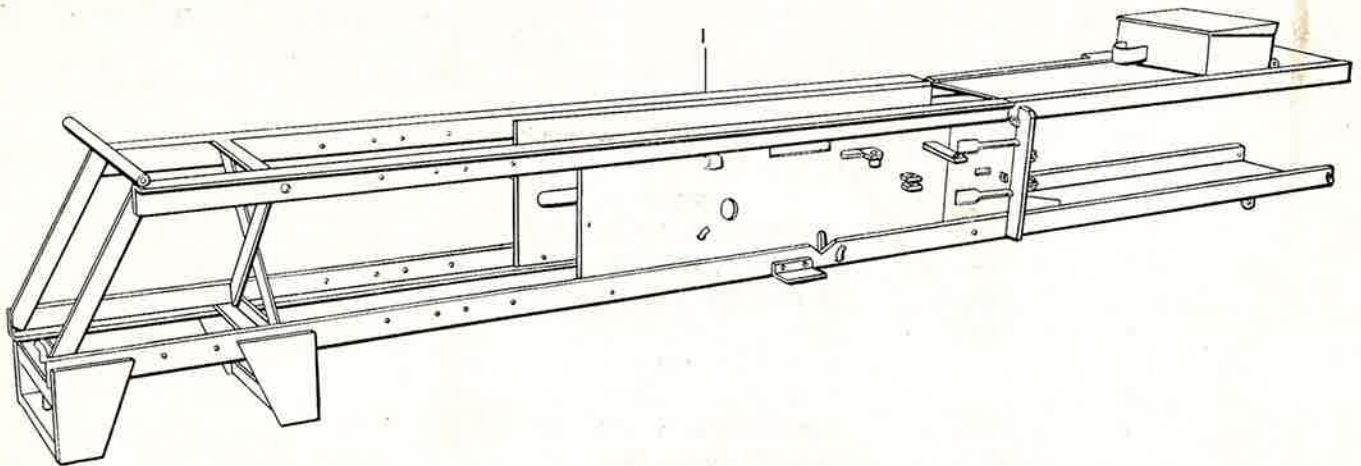

MAIN FRAME WELD ASSEMBLY

Ref. No.	Part No.	Description
1	11669	Main Frame Weld Assembly

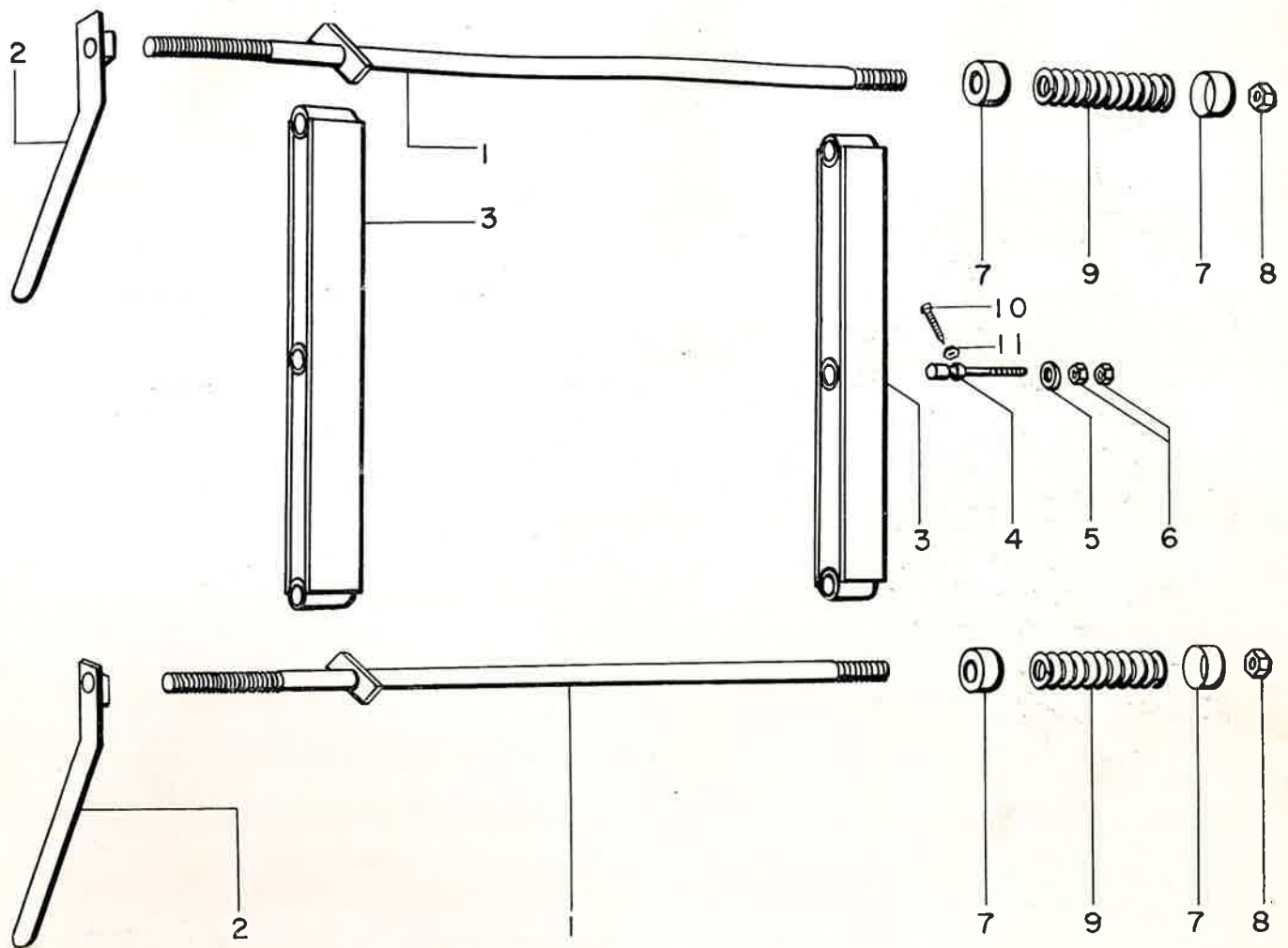

BALE TENSION SPRING ASSEMBLY

Ref. No.	Part No.	Description
1	14355	Bale Tension Bolt (2 Used)
2	H423	Tension Bolt Handle (2 Used)
3	13430	Tension Bar Assembly (2 Used)
4	14200	Pressure Pin
5		7/16" Flat Washer
6		7/16" Nut
7	14199	Bale Tension Spring Clip (4 Used)
8		Tension Spring Nut
9	13935	Bale Tension Spring for Straw Baling (2 Used)
	13936	Bale Tension Spring for Hay Baling (2 Used)
		(Not Shown)
10		3/8" x 1" Set Screw
11		3/8" Jam Nut

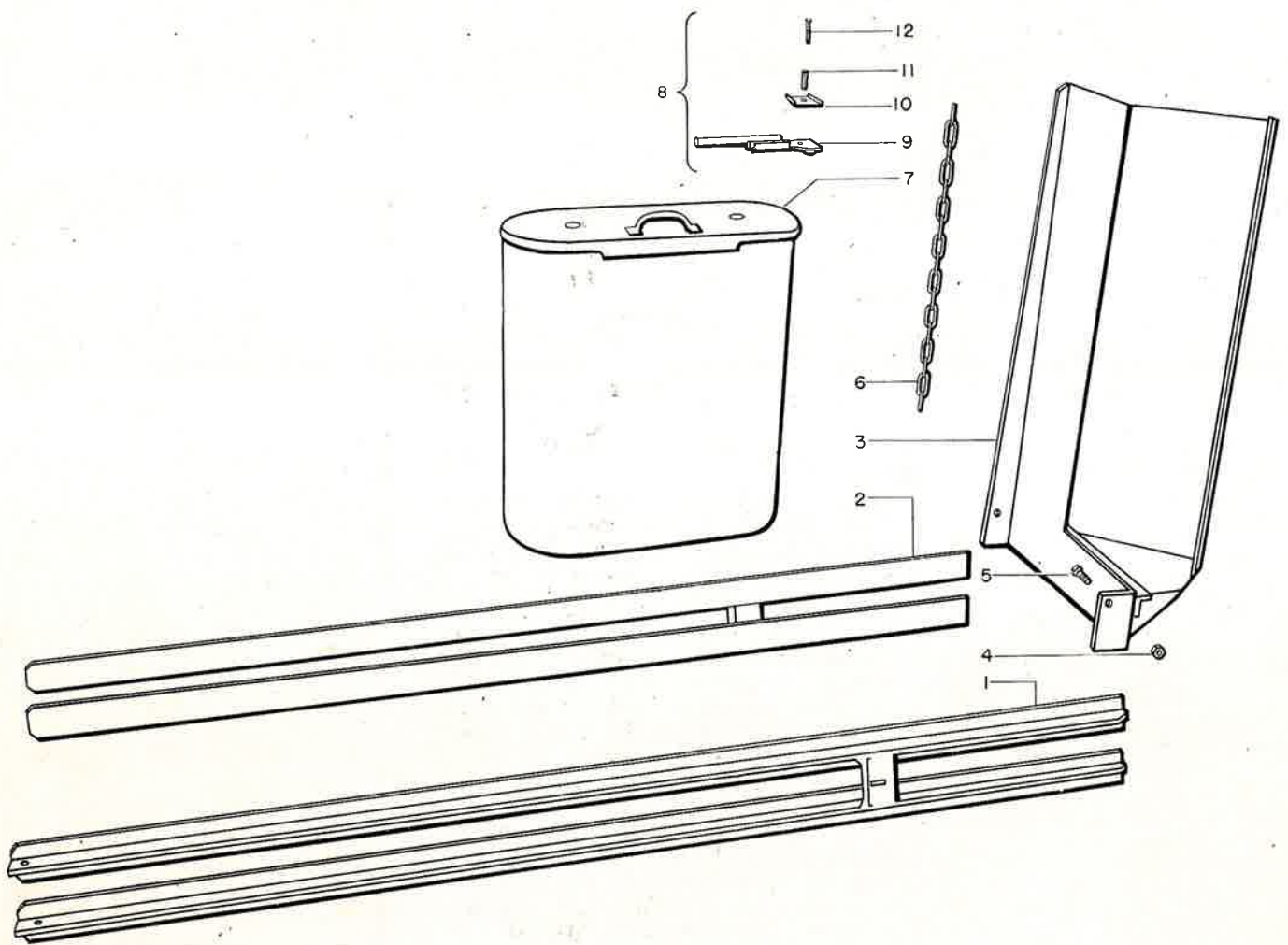

TENSION RAIL, BALE CHUTE, TWINE BOX AND TWINE TENSION ASSEMBLY

Ref. No.	Part No.	Description
1	11655	Tension Rail Assembly (Left)
2	13432	Tension Rail Assembly (Right)
3	13351	Bale Chute
4		$\frac{3}{8}$ " Self Locking Nut
5		$\frac{3}{8}$ " x 2" Carriage Bolt
6	12698	Chain for Bale Chute
7	H509	Twine Box
8	13361	Twine Tension Clamp Assembly (Consisting of Ref. Nos. 9, 10, 11, and 12)
9	13441	Twine Tension Base
10	13445	Twine Tension Clamp Plate
11	H25	Twine Tension Spring
12		$\frac{1}{4}$ " x $1\frac{1}{4}$ " R. H. Stove Bolt



Farm Accidents Can Be Prevented with Your Help

No accident prevention program can be successful without the whole-hearted cooperation of the person who is directly responsible for the operation of equipment.

To read accident reports from all over the Country is to be convinced that a large number of accidents can be prevented only by the operator anticipating the result before the accident is caused and doing something about it. No power-driven equipment, whether it be transportation or processing, whether it be on the highway, in the harvest field or in the industrial plant, can be safer than the man who is at the controls. If farm accidents are to be prevented—and they can be prevented—it will be done by the operators who accept a full measure of their responsibility.

It is true that the designer, the manufacturer, the safety engineer can help; and they will help, but their combined efforts can be wiped out by a single careless act of the operator.

It is said "that the best kind of a safety device is a careful operator." We ask you to be that kind of an operator.

NATIONAL SAFETY COUNCIL

REGISTER YOUR WARRANTY

With your Model 77 Automatic Baler comes a card carrying the terms of the warranty on the machine. Read it. Then tear off the reply half of the card, fill in your name and address and mail the card to us.

**NO STAMP IS NEEDED. THIS CARD WILL COME BACK TO US
AND WE'LL PAY THE POSTAGE AT THE FACTORY!**

As soon as this card is received, your warranty is registered and you are protected within the limits of the warranty. If you are unable to find the warranty card, send us the Baler Serial Number, together with date of purchase and the name of the dealer from whom you bought it and we will send you a duplicate Warranty Card immediately.

When your card is registered, your name is automatically placed on our list to receive periodically by mail the latest information on new attachments, methods, and machines developed by the New Holland Machine Company.



NEW HOLLAND MACHINE COMPANY

NEW HOLLAND, PENNSYLVANIA