

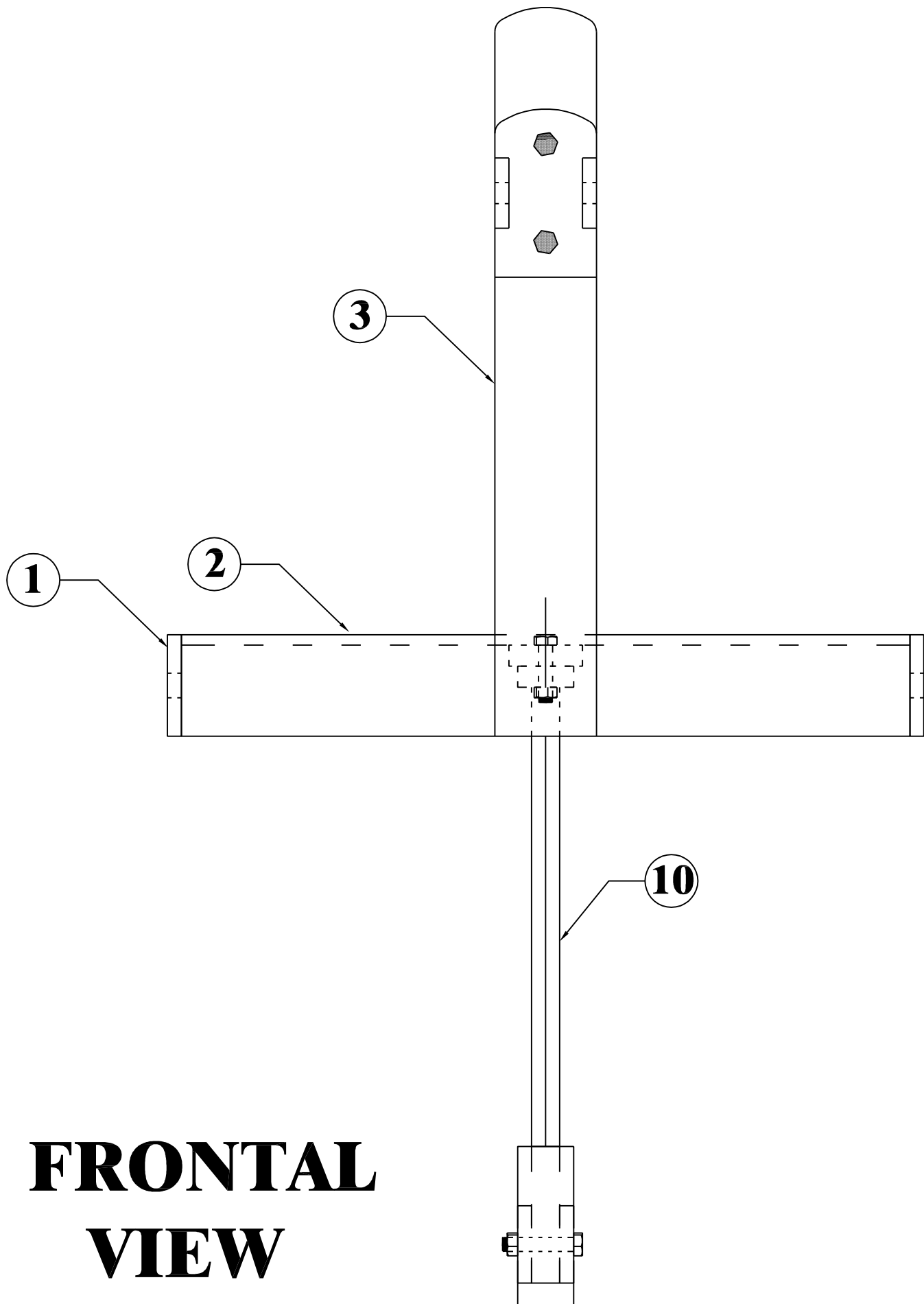

2005/12/31

Design by:
Kenneth F. Crisman



**FRONTAL
VIEW**

SIDE VIEW

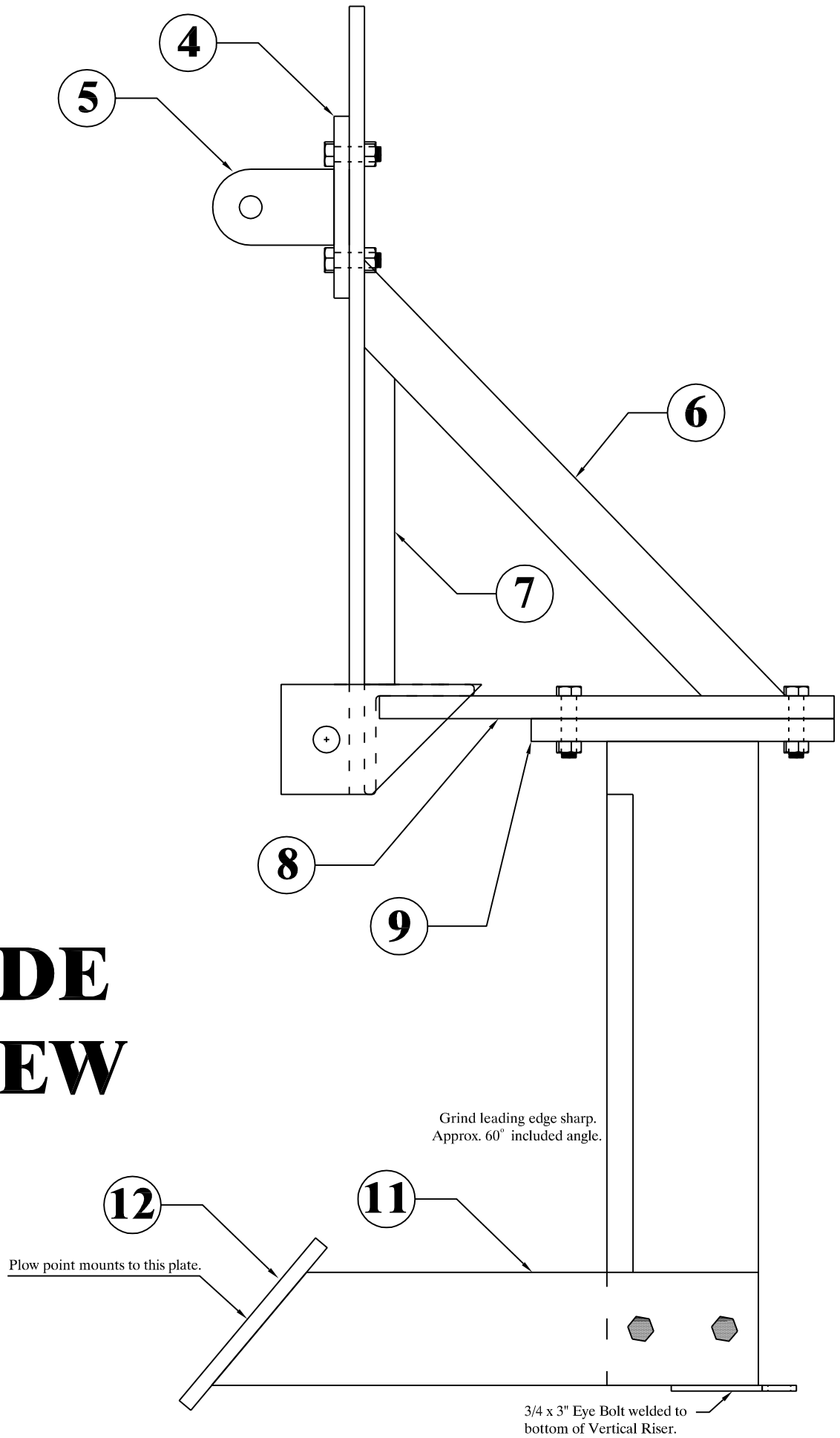

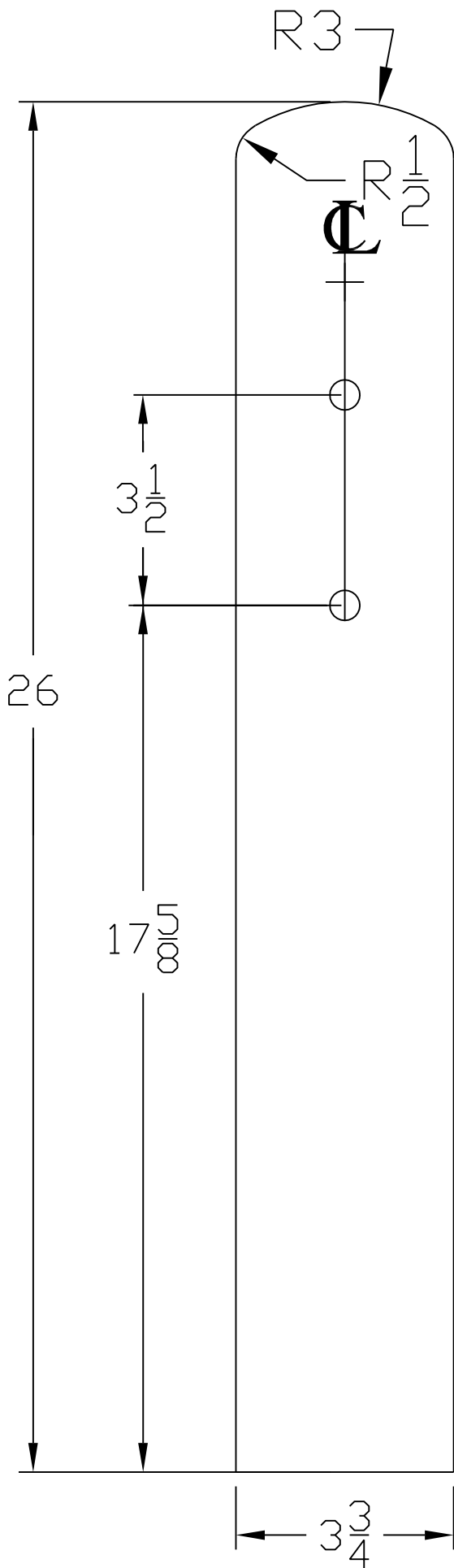

TOP LINK SUPPORT POST

(1) Required

MATERIAL: 1/2" Steel
 Round Top for Appearance

TOP LINK ATTACHMENT BACK

(1) Required

MATERIAL: 1/2" Steel

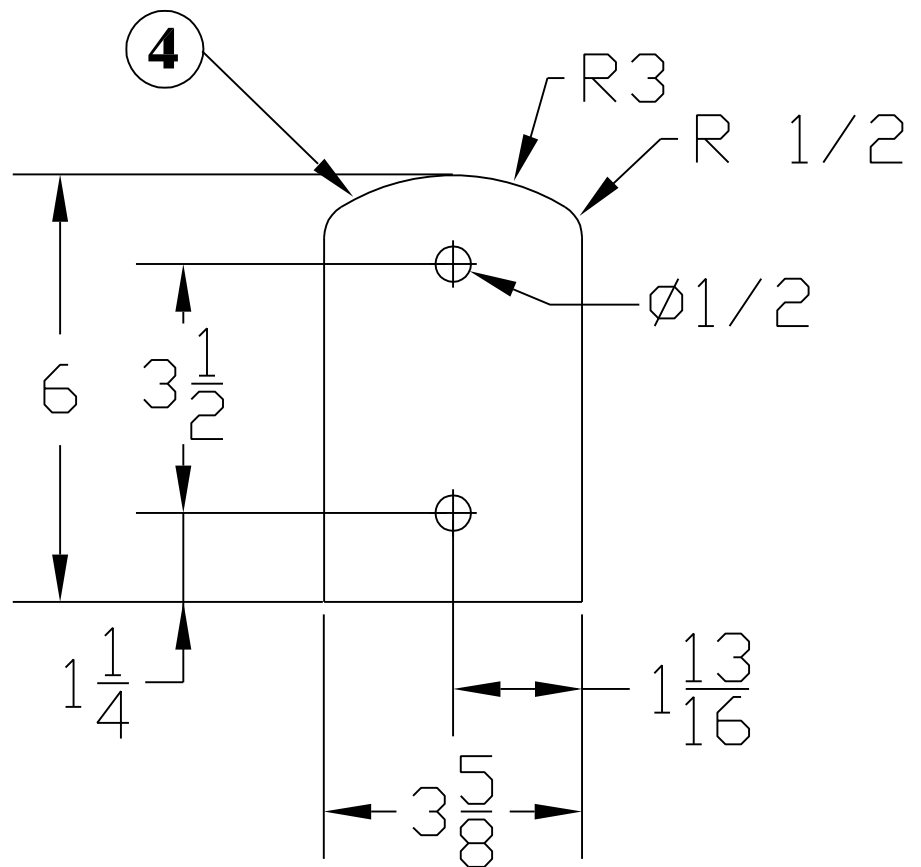

All Bolts Grade 8, 1/2 " Diameter
 with Lock Washers. Quan. 2 ea.

LENGTHS: 2 " 2 1/2" 3"

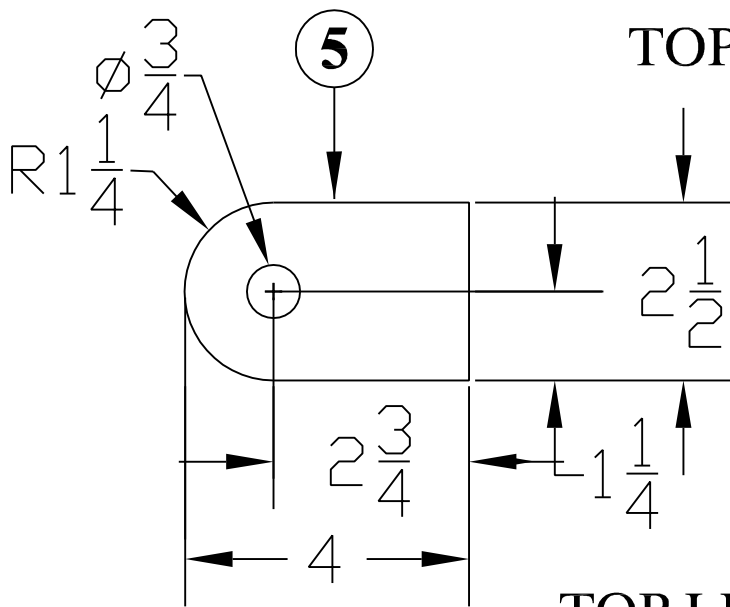

TOP LINK ATTACHMENT EARS

(2) Required

MATERIAL: 1/2" Steel

TOP LINK ATTACHMENT ASS'Y

Weld both ears **SOLID**.

Weld Items **5** to **4**

Attach to Item **3**

using (2) 2" bolts

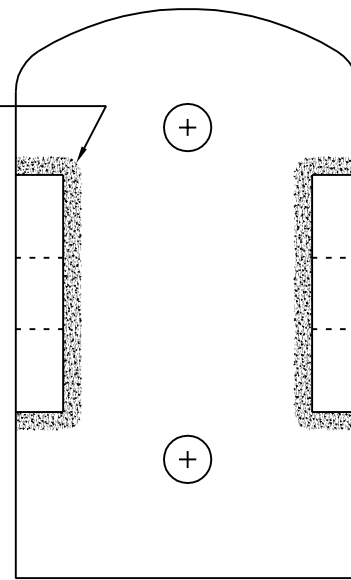

HITCH PIN MOUNTING PLATE

(2) Required

MATERIAL: 1/2" Steel

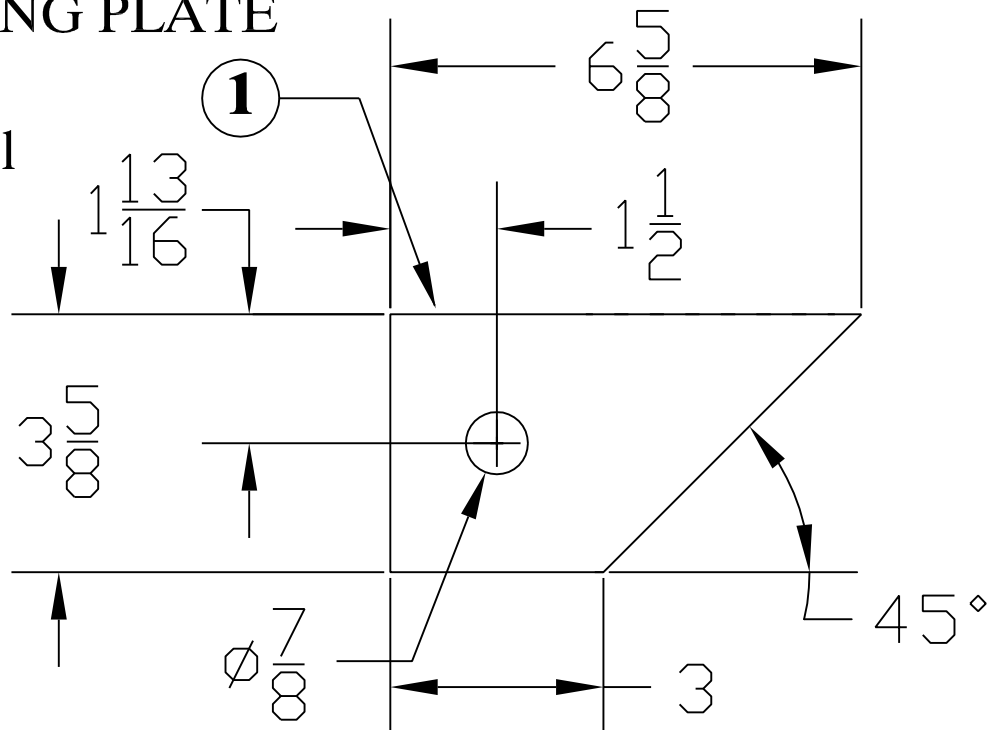

DRAW BAR

(1) Required

MATERIAL: 3 5/8 X 3 5/8 X 3/8

Angle Iron

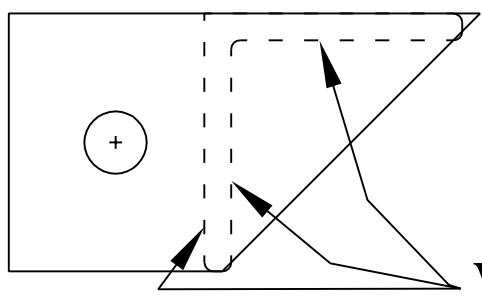
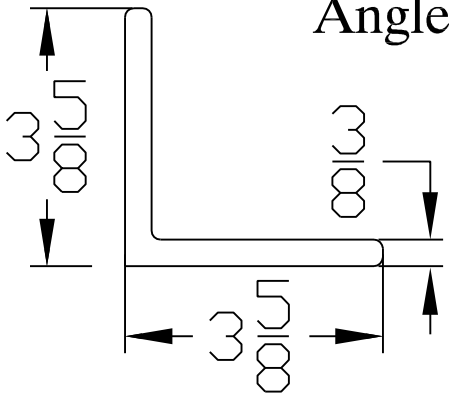

Weld solid all three joining surfaces. Both Ends.

ASSEMBLE ITEMS

1 AND **2**

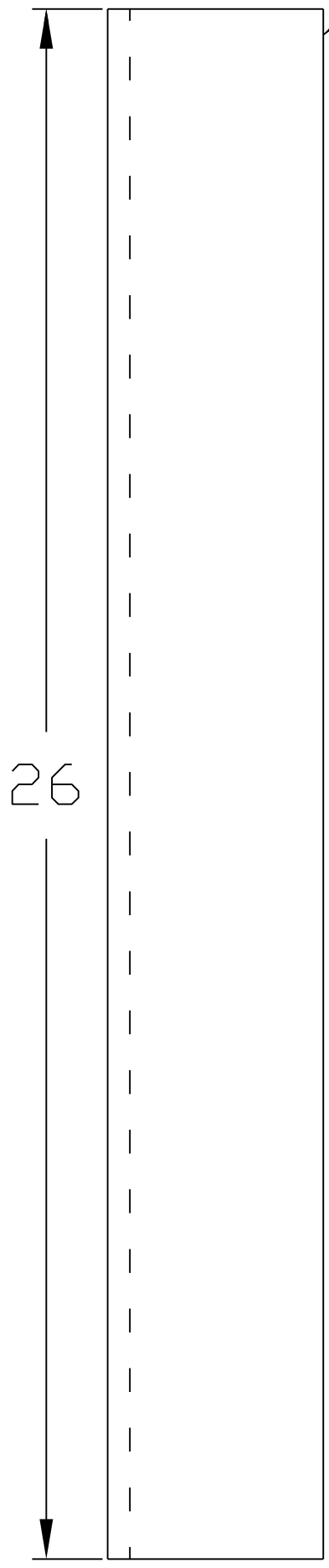

ANGLE BRACE
(2) Required
MATERIAL: 1/2" STEEL

6

VERTICAL BRACE
(2) Required
MATERIAL: 1/2" STEEL

7

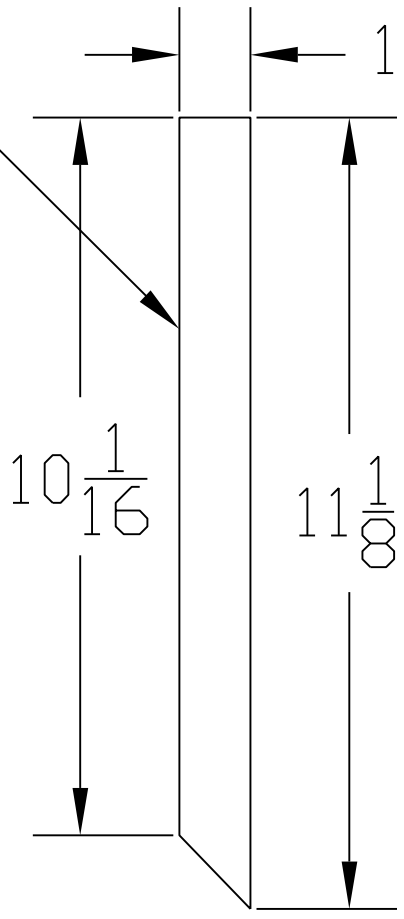
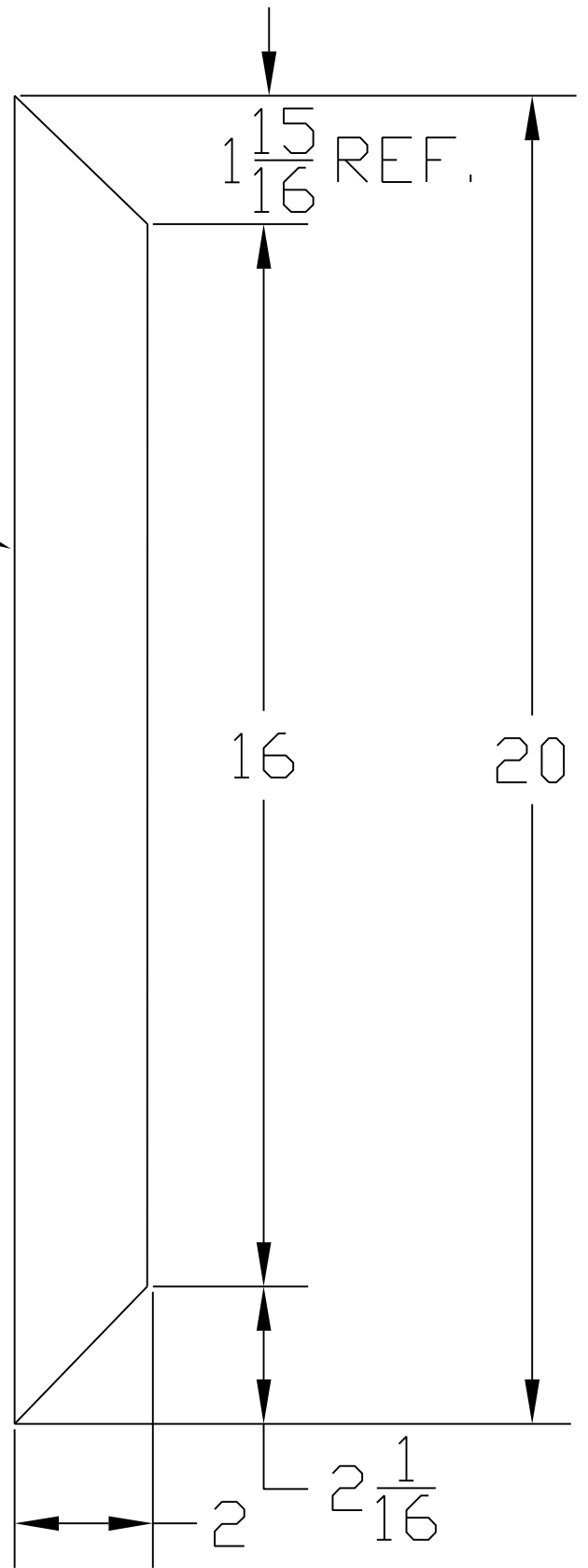

REAR PLATFORM

(1) Required
MATERIAL: 3/4" STEEL

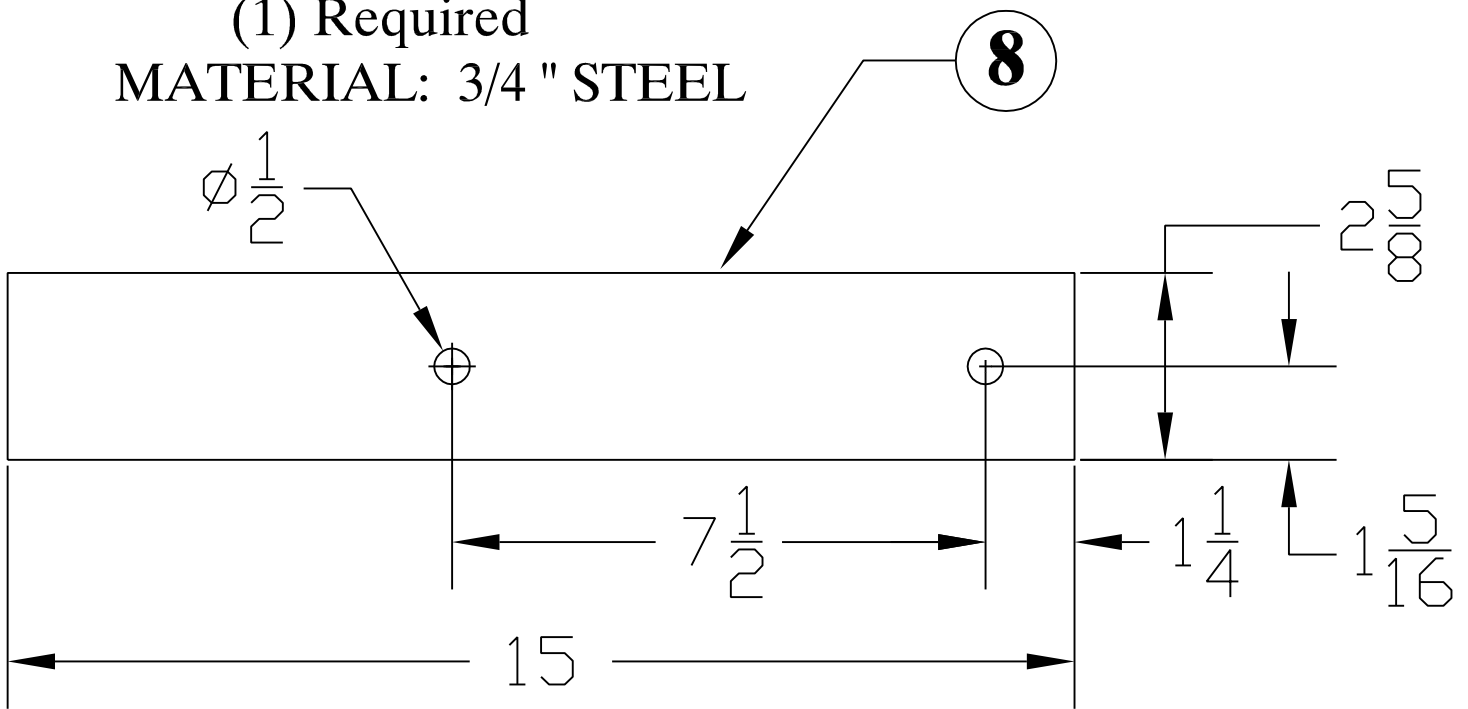

TOP PLATE - PLOW ASSEMBLY

(1) Required
MATERIAL: 3/4" STEEL

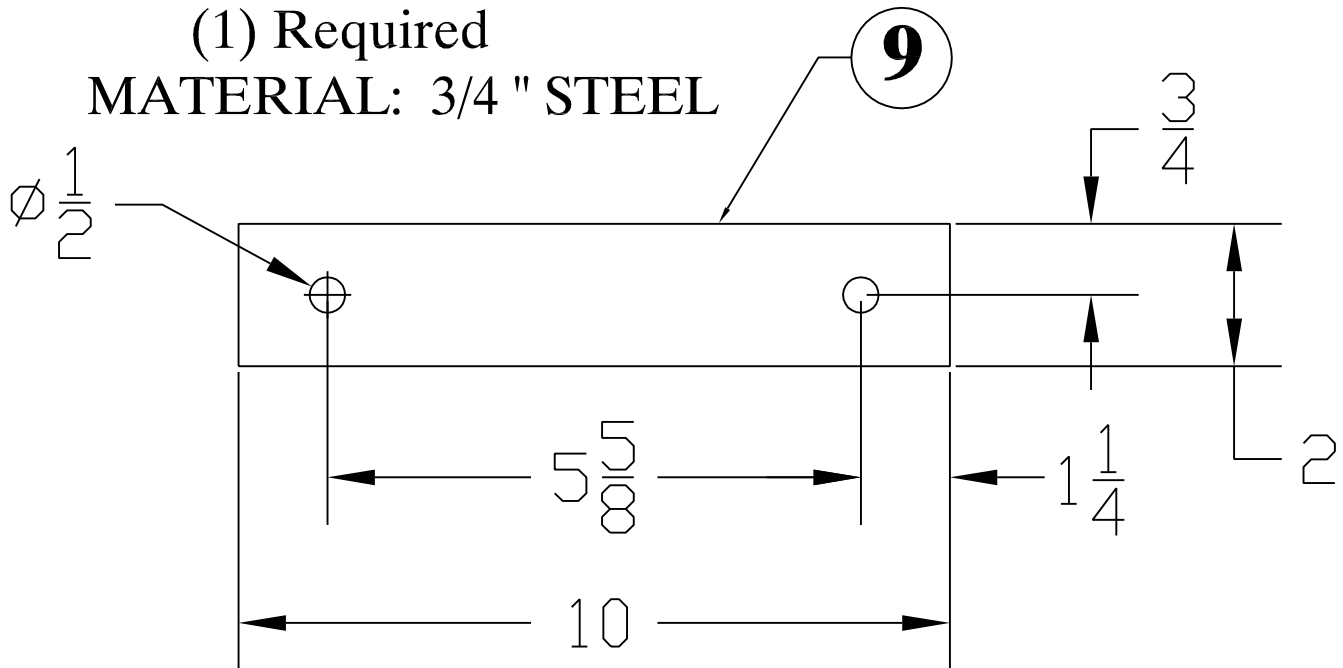

Attach to Item **8** with (2) 2 1/2" Bolts

VERTICAL RISER - PLOW ASSEMBLY

(1) Required
MATERIAL: 1" STEEL

10

Grind leading edge sharp.
Approx. 60° included angle.

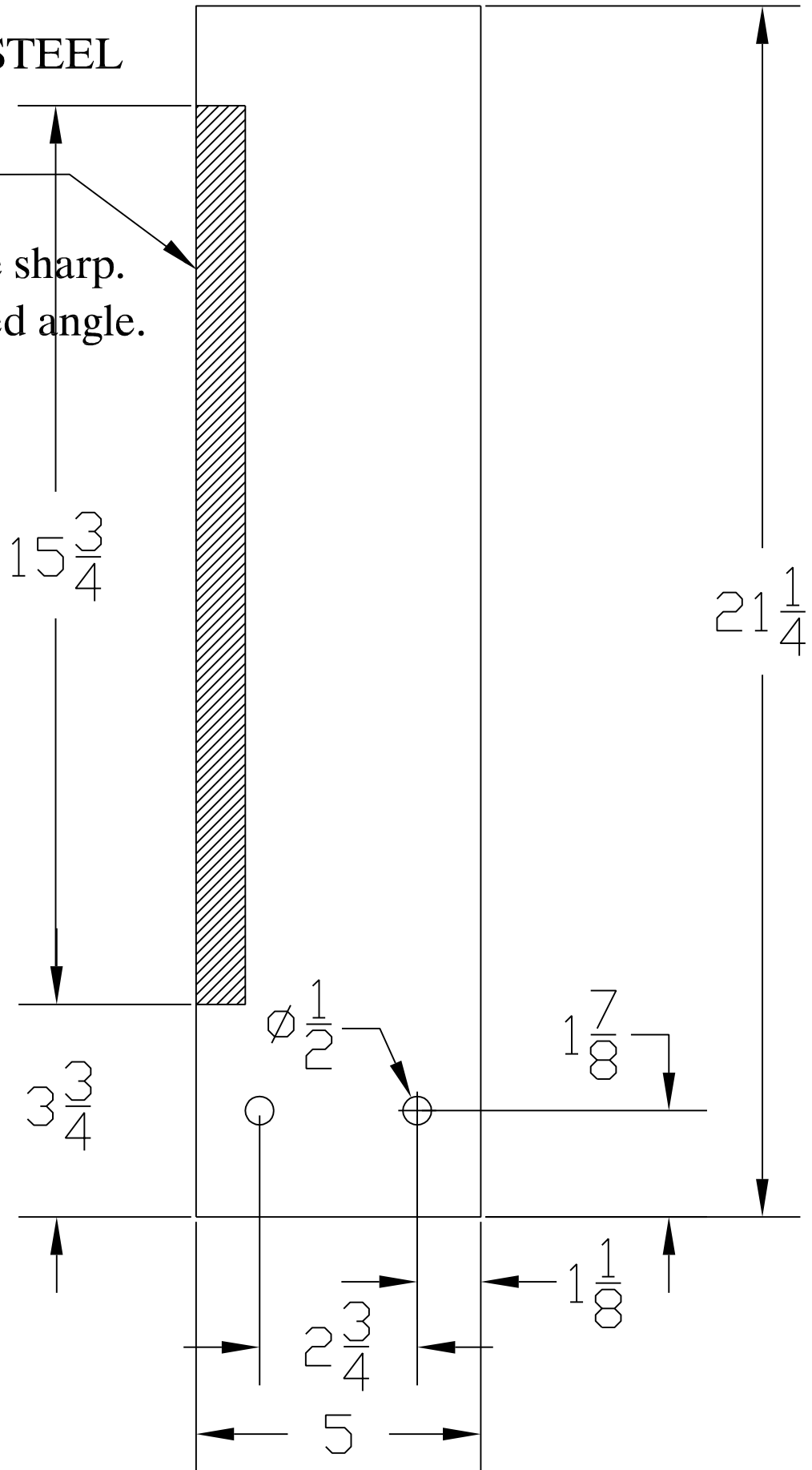

Sandwich Item **10** between (2) Items **11** using (2) 3" bolts.

HORIZONTAL SUPPORT - PLOW ASSEMBLY

(2) Required

MATERIAL: 1/2" STEEL

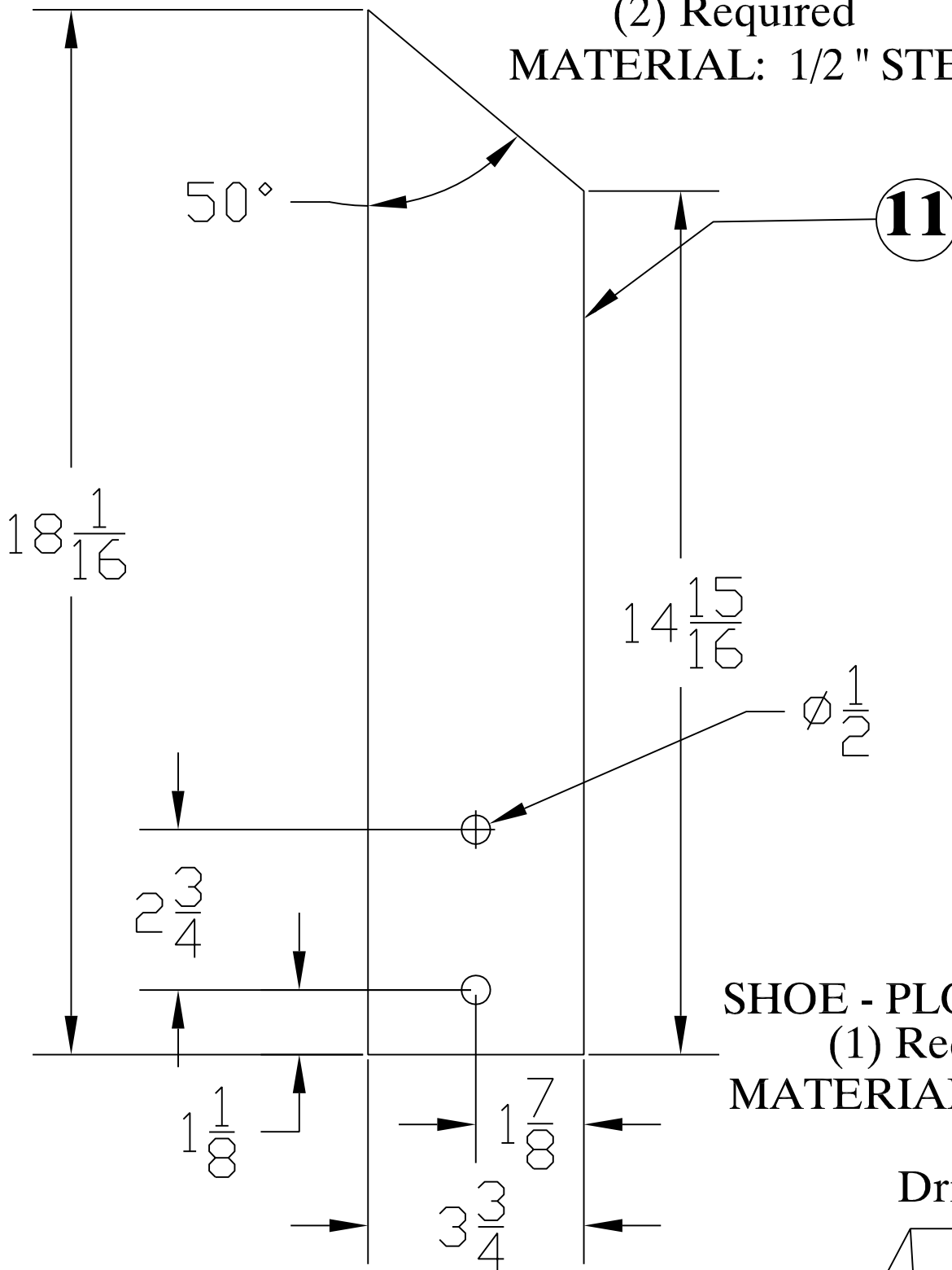

Weld to front slope on (2) Items

11